

PROJECT TEAM:

OWNER: CITY OF LATHROP
390 TOWNE CENTER DRIVE
LATHROP, CA 95330
PHONE: (209) 941-7363 FAX: (209) 941-7449
CONTACT: KEN REED

CIVIL ENGINEER: MACKAY & SOMPS CIVIL ENGINEERS, INC. 5142
FRANKLIN DRIVE, SUITE B
PLEASANTON, CA 94588
PHONE: (925) 225-0690 FAX: (925) 225-0698
CONTACT: JON FERRELL

GEOTECHNICAL ENGINEER: ENGeo INC. 17278 GOLDEN
VALLEY PARKWAY
LATHROP, CA 95330
PHONE: (209) 835-0610
CONTACT: STYVE HARRIS

CITY OF LATHROP LATHROP GENERATIONS CENTER PARKING LOT

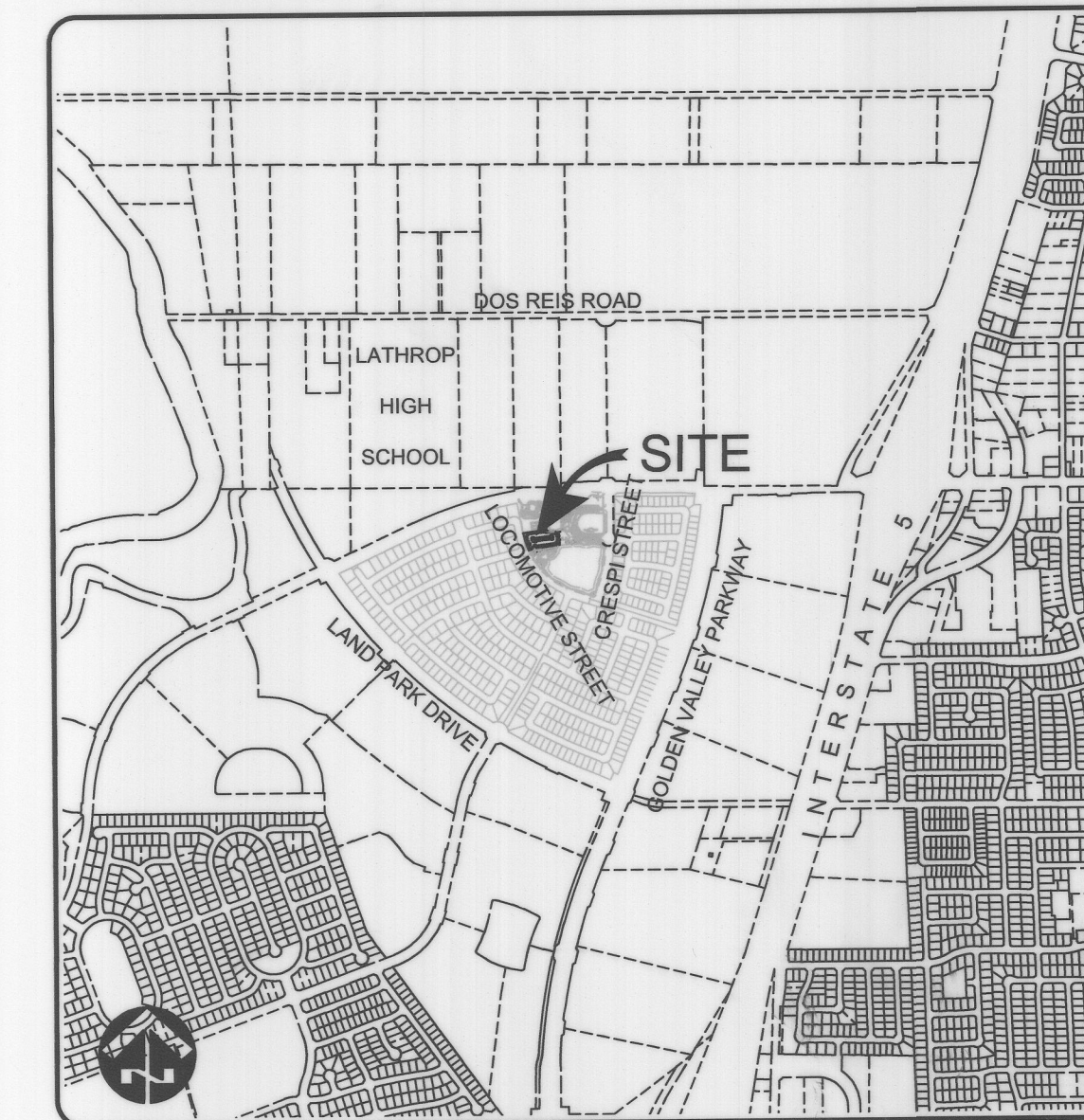

VICINITY MAP
NTS

TABLE OF CONTENTS

SHEET	DESCRIPTION
C1	COVER SHEET
C2	GENERAL NOTES
C3	DETAILS AND SECTIONS
C4	HORIZONTAL CONTROL PLAN
C5	GRADING PLAN & SITEWORK PLAN
C6	UTILITY PLAN
C7	SIGNING AND STRIPING PLAN
C8	EROSION CONTROL PLAN & DETAILS

CITY STANDARD DETAILS (REFERENCE VERSION 2019)

- R-5 CONCRETE CURB, GUTTER AND SIDEWALK CONSTRUCTION SPECIFICATIONS
- R-7A VERTICAL CURB, GUTTER AND SIDEWALK
- R-7B VERTICAL CURB AND GUTTER WITH DETACHED SIDEWALK
- R-7C CONCRETE PATH
- R-10A/B/C CURB RAMP DETAILS
- R-10F HANDICAP RAMP DOME DETAILS
- R-16A TYPICAL RESIDENCE DRIVEWAY SEPARATED SIDEWALK
- R-23 STOP AND YIELD STRIPING DETAILS
- R-28B TRENCH BACKFILL EXISTING OR FUTURE PAVED AREAS

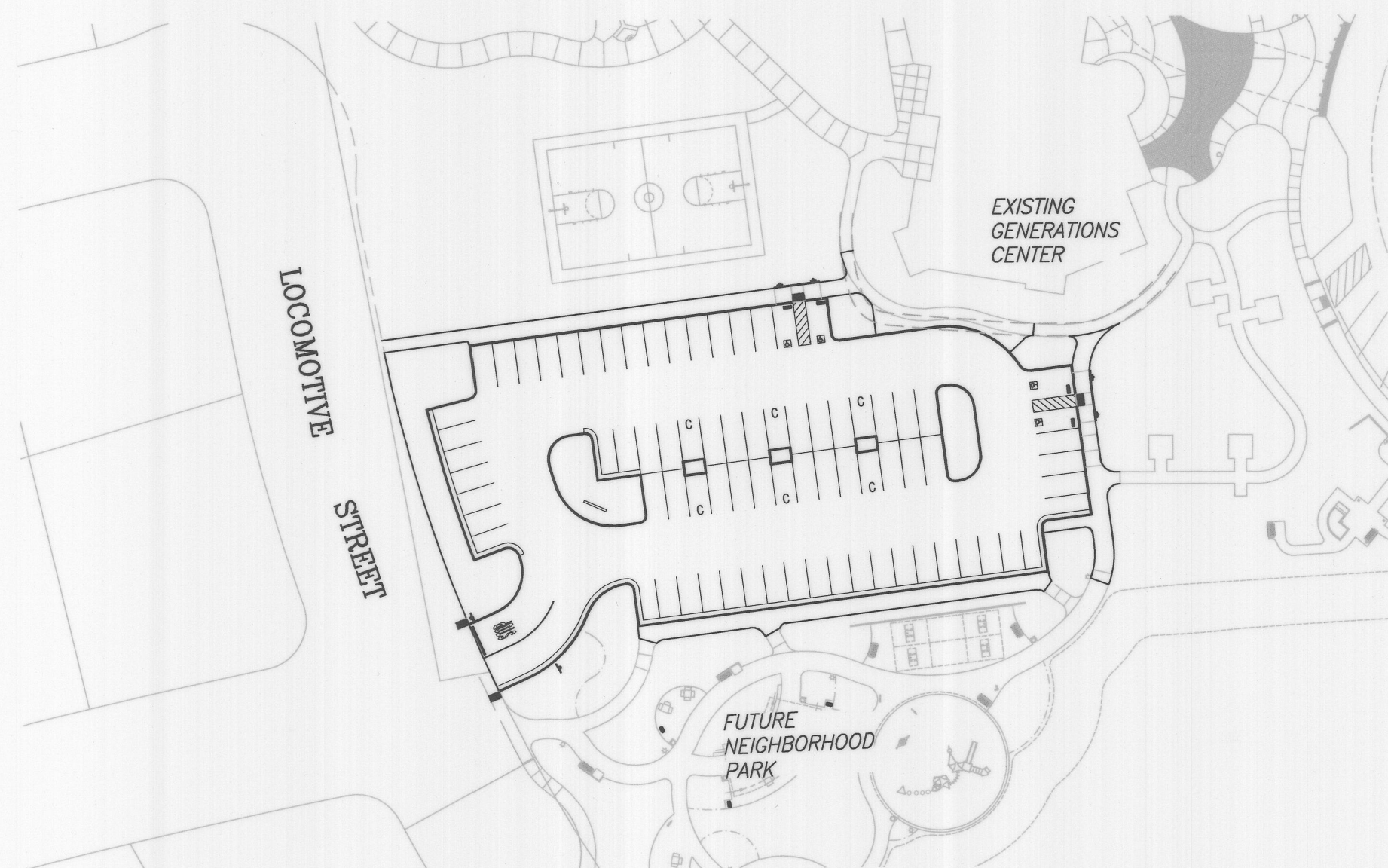

SITE PLAN

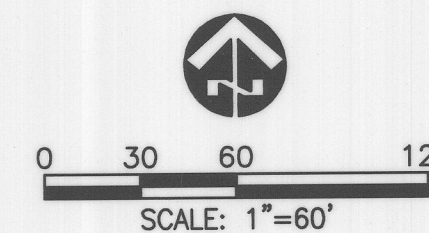

LEGEND:

- 2.00% SLOPE
- BOUNDARY LINE
- OVERLAND RELEASE PATH (DIRECTION)
- EXISTING CONTOUR
- EXISTING SPOT SHOT
- STORM DRAIN PIPE & MANHOLE
- STORM DRAIN CATCH BASIN
- LIMIT OF WORK
- EXISTING WATER PIPE
- ELEC. SLEEVE
- IRR. SLEEVE
- VERTICAL CURB
- CURB & GUTTER

BENCHMARK:

SAN JOAQUIN CO. BRASS DISK IN CURB, STAMPED "CITY OF LATHROP BENCHMARK NO. 5," 1.3 FEET EAST OF THE SOUTHEAST CURB RETURN OF LOUISE AVENUE AND HARLAN ROAD. ELEVATION = 14.77 NAVD29

BASIS OF BEARINGS:

THE BEARING OF N02°02'18"W BETWEEN FOUND MONUMENTS FOR THE EAST LINE OF THE SOUTHEAST QUARTER OF SECTION 33, T.1 S., R. 6 E. MOUNT DIABLO BASE AND MERIDIAN AS SHOWN ON THAT CERTAIN PARCEL MAP FILED FOR RECORD APRIL 13, 2006, IN BOOK 23 OF SURVEYS AT PAGE 192 SAN JOAQUIN COUNTY RECORDS, WAS TAKEN AS THE BASIS OF BEARINGS SHOWN HEREON.

CITY OF LATHROP
PARKS AND RECREATION DEPARTMENT

APPROVED BY: [Signature] DATE: 2-21-2020
Parks and Recreation Director

CITY OF LATHROP
ENGINEERING

APPROVED BY: [Signature] DATE: 2-21-2020
CITY ENGINEER
RCE NO. 34681
EXP. Sept 30, 2022

CITY OF LATHROP
PUBLIC WORKS DEPARTMENT

APPROVED BY: [Signature] EXP. DATE: 2/21/2020
PUBLIC WORKS DIRECTOR

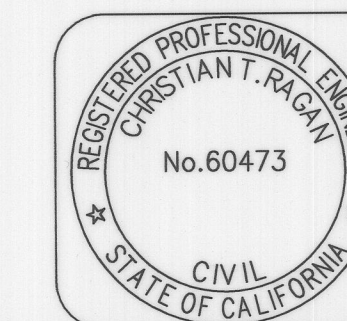

RECORD DRAWING

THESE ARE THE FINAL CONSTRUCTION PLANS FOR THE PROJECT WITH THE ADDITIONS NOTED FOR FIELD CHANGES BROUGHT TO THE ATTENTION OF THE ENGINEER BY THE DEVELOPER, CONTRACTOR, AND THE CITY INSPECTOR.

CHRISTIAN T. RAGAN
RCE #60473



GEOTECHNICAL ENGINEER REVIEW:
THESE PLANS HAVE BEEN REVIEWED AND FOUND TO BE IN GENERAL CONFORMANCE WITH THE INTENT AND PURPOSE OF THE GEOTECHNICAL REPORTS PREPARED BY ENGeo INC., DATED JULY 17, 2012 (ENGeo PROJECT NUMBER 9529.000.000).

[Signature] 2-19-20
ENGeo, INC DATE

LATHROP GENERATIONS CENTER
PARKING LOT

COVER SHEET

DEPARTMENT OF PUBLIC WORKS
CITY OF LATHROP, CALIFORNIA

DATE: FEBRUARY 2020	RECOMMENDED FOR APPROVAL BY: _____	PROJECT NO. 25227.010
SCALE: AS NOTED	DATE: _____	SHEET NO. C1
DRAWN BY: RH	DESIGNED BY: JF	SHEET 1 OF 8
CHECKED BY: JFT		

WARNING • CAUTION

EXISTING UNDERGROUND UTILITIES
CONTACT: UNDERGROUND SERVICE ALERT
PHONE: (800) 227-2600
FOR MARKING PRIOR TO DIGGING

ELECTRONIC VERSIONS OF THE LINework ON THIS PLAN MAY NOT BE CONSISTENT WITH OTHER DIMENSIONS, NOTES, DETAILS OR DESCRIPTIONS WHICH CONTROL THE INTENDED DESIGN. ELECTRONIC VERSIONS OF THIS PLAN ARE NOT TO BE USED TO ESTABLISH THE LOCATION OF PROPERTY OR IMPROVEMENTS IN THE FIELD.

NO.	DESCRIPTION	CHECKED BY	CITY APPROVAL APPROVED BY	DATE

Mackay & Somps
ENGINEERS
PLEASANTON, CA
(925)225-0690

PLANS PREPARED UNDER THE DIRECTION OF:

BY: [Signature] 2/13/20
JAMES F. TEMPLE JR. RCE #43061

CITY STANDARD NOTES:

- A. THESE PLANS HAVE BEEN CHECKED BY THE CITY OF LATHROP AND/OR ITS AUTHORIZED REPRESENTATIVE, BUT SUCH CHECKING AND/OR APPROVAL DOES NOT RELIEVE THE DEVELOPER FROM HIS RESPONSIBILITY TO CORRECT ERRORS, OMISSIONS OR MAKE CHANGES REQUIRED BY CONDITIONS DISCOVERED IN THE FIELD DURING THE COURSE OF CONSTRUCTION.
B. ALL REVISIONS TO THIS PLAN MUST BE REVIEWED BY THE CITY ENGINEER PRIOR TO CONSTRUCTION AND SHALL BE ACCURATELY SHOWN ON REVISED PLANS STAMPED AND SIGNED BY THE CITY PRIOR TO THE INSTALLATION OF THE IMPROVEMENTS.
C. ALL CONSTRUCTION AND MATERIAL SHALL CONFORM TO CITY OF LATHROP DESIGN AND CONSTRUCTION STANDARDS, THE PROJECT URBAN DESIGN CONCEPT (IF APPLICABLE), AND PER THE APPROVED PLANS. THE IMPROVEMENTS ARE SUBJECT TO THE INSPECTION AND APPROVAL OF THE PUBLIC WORKS DEPARTMENT. CONTACT PUBLIC WORKS CONSTRUCTION INSPECTOR AT (209) 941-7450, AT LEAST THREE (3) WORKING DAYS PRIOR TO START OF ANY WORK TO ARRANGE FOR INSPECTION.
D. NOTIFY UNDERGROUND SERVICE ALERT (USA -NORTH) AT "811" OR (800) 227- 2600 AT LEAST TWO (2) WORKING DAYS PRIOR TO EXCAVATION. THE USA AUTHORIZATION NUMBER SHALL BE KEPT AT THE JOB SITE.
E. IF NECESSARY TO CONFIRM FIELD LOCATIONS OF FACILITIES, EXPLORATORY TRENCHING OR POT-HOLING SHALL BE DONE AT THE EXPENSE OF THE CONTRACTOR
F. IF A CONFLICT OCCURS BETWEEN THE CITY OF LATHROP DESIGN AND CONSTRUCTION STANDARDS AND THE RECOMMENDATIONS BY THE DESIGN ENGINEER AND/OR SOILS ENGINEER, THE MORE STRINGENT SHALL APPLY AS DIRECTED BY THE CITY ENGINEER.
G. BASIS OF ELEVATION DATUM SHOWN ON COVER SHEET.
H. THE EXISTING UTILITIES ARE PLOTTED FROM AVAILABLE RECORDS. THE CONTRACTOR SHALL TAKE PRECAUTIONARY MEASURES TO PROTECT THESE UTILITIES. THE CONTRACTOR SHALL NOT EXCAVATE UNTIL ALL UTILITY AGENCIES AND THE CITY OF LATHROP HAVE BEEN NOTIFIED AND HAVE MARKED THEIR FACILITIES IN THE FIELD.
I. EXISTING UTILITIES SHALL NOT BE INTERRUPTED UNTIL THE UTILITY COMPANY HAS PROVIDED ALTERNATIVE SERVICE FACILITIES. THE CONTRACTOR SHALL COOPERATE AND COORDINATE HIS WORK WITH THE APPROPRIATE AGENCIES AND UTILITY COMPANIES.
J. FINAL PAVEMENT WORK SHALL NOT OCCUR WITHIN THE CITY RIGHT-OF-WAY PRIOR TO COMPLETION OF UTILITY RELOCATION WITHOUT THE SPECIFIC APPROVAL OF THE CITY ENGINEER.
K. ALL UTILITY TRENCHES IN EXISTING ROADWAY SHALL BE BACKFILLED AND OPENED TO PUBLIC TRAFFIC FOR A MINIMUM OF TWO WEEKS PRIOR TO PLACING PERMANENT PAVEMENT.
L. ALL CONSTRUCTION STAKING FOR GRADING, CURB, AND GUTTER, SIDEWALK, SANITARY SEWER, STORM DRAINS, WATER LINES, RECYCLED WATER, FIRE HYDRANTS, ELECTROLIERS, ETC. SHALL BE DONE BY A REGISTERED CIVIL ENGINEER OR A LICENSED LAND SURVEYOR.
M. ALL AREAS UNDERGOING GRADING, AND ALL OTHER CONSTRUCTION ACTIVITIES SHALL BE WATERED, OR OTHER DUST-PALLIATIVE MEASURES USED, TO PREVENT DUST, AS CONDITIONS WARRANT. WATER TRUCKS SHALL BE AVAILABLE AT ALL TIMES. THE PERSON RESPONSIBLE FOR DUST CONTROL, SHALL BE AVAILABLE 24 HOURS A DAY.
N. PRIOR TO RECEIVING/TAKING ANY WATER FROM THE CITY OF LATHROP WATER SYSTEM THE CONTRACTOR SHALL ACQUIRE A CITY WATER METER OR CITY FIRE HYDRANT METER. ALL WATER USAGE SHALL BE METERED.
O. ALL LINES ABANDONED DURING CONSTRUCTION SHALL BE REMOVED UNLESS OTHERWISE NOTED ON THE PLANS.
P. PRIOR TO TRENCHING FOR ANY SEWER, WATER, RECYCLED WATER, OR STORM DRAIN PIPE, THE CONTRACTOR SHALL VERIFY, IN THE FIELD, THE SIZE AND THE LOCATION OF THE EXISTING PIPE AT THE POINT OF CONNECTION. ANY DEVIATION FROM THE PLANS SHALL BE RESOLVED BY THE DESIGN ENGINEER PRIOR TO TRENCHING. ANY DAMAGE CAUSED BY TRENCHING TO EXISTING UNDERGROUND UTILITIES SHALL BE THE SOLE RESPONSIBILITY OF THE CONTRACTOR.
Q. ALL TRENCHES SHALL BE BACKFILLED IN ACCORDANCE WITH CITY STANDARD DETAILS. COMPACTION SHALL BE ACHIEVED BY MECHANICAL MEANS. NO FLOODING, PONDING, OR JETTING SHALL BE PERMITTED.
R. TESTING:
1. ALL INDEPENDENT LABORATORY INSPECTIONS CALLED FOR BY THE CITY ENGINEER WILL BE PAID FOR BY THE DEVELOPER OR CONTRACTOR.
2. ROADWAY SUB-GRADE, SUB-BASE, BASE, AND TRENCH BACKFILL COMPACTION TESTING SHALL BE PERFORMED BY A SOILS LAB CONTRACTING WITH THE CITY OF LATHROP AT THE DEVELOPER'S EXPENSE.
3. R-VALUE TESTING OF THE PAVEMENT SUB-GRADE SHALL BE PERFORMED PRIOR TO THE INSTALLATION OF BASE ROCK, OR AS REQUIRED BY THE CITY ENGINEER.
4. A MINIMUM OF 48 HOURS' NOTICE IS REQUIRED TO SCHEDULE ALL SPECIAL INSPECTION/TESTING SERVICES.

CITY STANDARD NOTES CONTINUED:

- S. ASBESTOS CEMENT PIPE (ACP) OR VITRIFIED CLAY PIPE (VCP) OR FITTINGS SHALL NOT BE USED WITHIN THE CITY OF LATHROP.
T. EXISTING CURB, GUTTER AND SIDEWALKS WITHIN THE PROJECT LIMITS THAT ARE DAMAGED OR DISPLACED, SHALL BE REPAIRED OR REPLACED PER THE CITY DESIGN AND CONSTRUCTION STANDARDS BY THE CONTRACTOR.
U. NO TREES SHALL BE REMOVED UNLESS THEY ARE SHOWN AND NOTED TO BE REMOVED ON THE IMPROVEMENT PLANS. ALL TREES CONFLICTING WITH GRADING, UTILITIES, OR OTHER IMPROVEMENTS, OR OVERHANGING THE SIDEWALK OR PAVEMENT TO FORM A NUISANCE OR HAZARD, SHALL BE TRIMMED AND PROPERLY TREATED AND SEALED. THE DRIP LINE OF TREES TO BE SAVED WILL BE FENCED, AND NO GRADING SHALL TAKE PLACE WITHIN THIS FENCED AREA.
V. THE FULL STRUCTURAL SECTION OF THE MAJOR STREETS SHALL BE CONTINUED THROUGH THE INTERSECTIONS.
W. BENCHMARKS SHALL BE FURNISHED AND INSTALLED BY THE CONTRACTOR AT LOCATIONS SHOWN. THE DEVELOPER'S ENGINEERS SHALL STAMP THE BENCHMARKS PER STANDARD DETAIL R-26 AND FURNISH THE CITY ENGINEER WITH THE BENCHMARK ELEVATION DATA.
X. STREET SIGNS SHALL BE INSTALLED AT ALL INTERSECTIONS THAT MEET THE UDC STANDARDS (IF APPLICABLE) PER CITY DESIGN AND CONSTRUCTION STANDARDS.
Y. TRAFFIC CONTROL DEVICES AND INSTALLATIONS SHALL BE IN CONFORMANCE WITH CALIFORNIA MANUAL ON UNIFORM TRAFFIC CONTROL DEVICES, AND MUST MEET THE UDC STANDARDS (IF APPLICABLE).
Z. ALL STREET MONUMENTS, LOT CORNER, BENCHMARKS AND OTHER PERMANENT PIPE OR MONUMENTS DISTURBED DURING THE PROCESS OF CONSTRUCTION SHALL BE REPLACED BY A LICENSED CIVIL ENGINEER OR SURVEYOR PRIOR TO ACCEPTANCE OF IMPROVEMENTS BY THE CITY.
IF A MONUMENT IS LOCATED WITHIN THE BOUNDARY OF THE PROJECT, THE CONTRACTOR SHALL SUBMIT THE ACKNOWLEDGEMENT OF MONUMENT RESPONSIBILITY "PRE- CONSTRUCTION" FORM, FOUND IN APPENDIX E OF THESE STANDARDS, TO THE CITY DURING THE ENCROACHMENT PERMIT APPLICATION PHASE. IN ADDITION, THE CONTRACTOR SHALL SUBMIT THE ACKNOWLEDGEMENT OF MONUMENT RESPONSIBILITY "POST-CONSTRUCTION" FORM, FOUND IN APPENDIX E OF THESE STANDARDS, TO THE CITY WHEN THE WORK IS COMPLETE.
AA. ESCPS MUST BE PREPARED CONSISTENT TO THE CITY'S DESIGN AND CONSTRUCTION STANDARDS AND ORDINANCES. SWPPPS MUST BE PREPARED BY A QUALIFIED SWPPP DEVELOPER AND BE COMPLIANT WITH THE STATE'S CONSTRUCTION GENERAL PERMIT. EROSION AND SEDIMENT CONTROL MEASURES MUST BE IN PLACE AT ALL TIMES DURING THE CONSTRUCTION PROJECT UNTIL FINAL SITE STABILIZATION IS ACHIEVED. THE PERSON RESPONSIBLE FOR THE DAILY MAINTENANCE OF THE FACILITIES IS _____ AND CAN BE REACHED 24 HOURS A DAY AT _____. THESE FACILITIES SHALL CONTROL AND CONTAIN EROSION-CAUSED SEDIMENT DEPOSITS AND PROVIDE FOR THE SAFE DISCHARGE OF SEDIMENT-FREE STORM WATER INTO EXISTING STORM DRAIN FACILITIES.
BB. IF THE PROJECT IS APPLICABLE TO THE STATE'S CONSTRUCTION GENERAL PERMIT, A NOTICE OF INTENT (NOI) TO COMPLY WITH THE NPDES GENERAL PERMIT FOR STORMWATER RUN-OFF ASSOCIATED WITH CONSTRUCTION ACTIVITY SHALL BE SUBMITTED TO THE SWRCB VIA THE STATE'S SMARTS SYSTEM. THE WQID# SHOULD BE INDICATED ON THE PLANS. A STORMWATER POLLUTION PREVENTION PLAN (SWPPP) SHALL BE SUBMITTED FOR APPROVAL BY THE CITY ENGINEER.
CC. IF, DURING CONSTRUCTION, ARCHAEOLOGICAL REMAINS ARE ENCOUNTERED, CONSTRUCTION IN THE VICINITY SHALL BE HALTED, AN ARCHAEOLOGIST CONSULTED AND THE CITY COMMUNITY DEVELOPMENT DEPARTMENT NOTIFIED. IF, IN THE OPINION OF THE ARCHAEOLOGIST, THE REMAINS ARE SIGNIFICANT, MEASURES, AS MAY BE REQUIRED BY THE COMMUNITY DEVELOPMENT DIRECTOR, SHALL BE TAKEN TO PROTECT THEM.
DD. WORK SHALL BE RESTRICTED TO WEEKDAYS BETWEEN 8:00 AM TO 5:00 PM AND WEEKENDS BY CITY APPROVAL. WORK WHICH REQUIRES ANY TRAFFIC LANE CLOSURES OR RESTRICTING OF THE TRAVELED WAY SHALL BE LIMITED TO 9:00 AM TO 3:30 PM IN THE COMMUTE DIRECTION AND 8:00 AM TO 4:30 PM IN THE NON-COMMUTE DIRECTION.
EE. THE OVERTIME COST FOR INSPECTING WORK PERFORMED BEFORE 8:00 AM, AFTER 5:00 PM, WEEKENDS, AND HOLIDAYS, THAT REQUIRE CITY INSPECTION, SHALL BE PRE- PAID BY THE CONTRACTOR OR DEVELOPER BEFORE THE WORK IS AUTHORIZED.
FF. CONSTRUCTION EQUIPMENT WHICH OPERATES AT A NOISE LEVEL IN EXCESS OF 85 DECIBELS (MEASURED ON THE A-WEIGHTED SCALE DEFINED IN ANSI S-1.4) AT A DISTANCE OF 100 FEET FROM THE EQUIPMENT IS PROHIBITED.
GG. THE CONTRACTOR SHALL KEEP EXCAVATIONS FREE FROM WATER DURING CONSTRUCTION. THE STATIC WATER LEVEL SHALL BE DRAWN DOWN A MINIMUM OF 2 FEET BELOW BOTTOM OF EXCAVATIONS TO MAINTAIN AN UNDISTURBED STATE OF NATURAL SOILS AND ALLOW PLACEMENT OF FILL TO THE SPECIFIED DENSITY. DISPOSAL OF WATER SHALL NOT DAMAGE PROPERTY OR CREATE A PUBLIC NUISANCE. CONTRACTOR SHALL DETERMINE METHOD OF DEWATERING AND LOCATION FOR DISCHARGE/DISPOSAL.
HH. DISPOSAL OF WATER INTO THE CITY SANITARY SEWER SYSTEM IS STRICTLY PROHIBITED.
II. DISPOSAL OF WATER INTO THE EXISTING STORM DRAIN SYSTEM MUST BE APPROVED IN WRITING BY THE CITY ENGINEER PRIOR TO DISPOSAL.

CITY STANDARD NOTES CONTINUED:

- JJ. CONTRACTOR SHALL MAINTAIN ALL STREETS, SIDEWALKS, AND ALL OTHER PUBLIC RIGHT-OF-WAYS IN A CLEAN, SAFE, AND USABLE CONDITION THROUGHOUT THE COURSE OF CONSTRUCTION. ALL SPILLAGE OF SOIL, ROCK, CONSTRUCTION DEBRIS, ETC., SHALL BE REMOVED IMMEDIATELY FROM PUBLICLY OWNED PROPERTY. ALL ADJACENT PROPERTY, PRIVATE OR PUBLIC, SHALL BE MAINTAINED IN A CLEAN, SAFE, AND USABLE CONDITION. THE CONTRACTOR SHALL PROVIDE FOR SAFE, UNOBSTRUCTED ACCESS TO PRIVATE PROPERTY ADJACENT TO WORK THROUGHOUT THE PERIOD OF CONSTRUCTION. CONTRACTOR SHALL PROVIDE TO THE PUBLIC WORKS DEPARTMENT THE NAME AND TELEPHONE NUMBER OF THE RESPONSIBLE PERSON AVAILABLE 24 HOURS A DAY IF ANY PROBLEMS OR CONDITIONS ARE NOT MET.
KK. ALL TRASH, CONSTRUCTION DEBRIS AND MATERIALS SHALL BE CONTAINED WITHIN PROPER CONTAINERS AND REMOVED ON A WEEKLY BASIS.
LL. THE CONTRACTOR SHALL KEEP ADJOINING PUBLIC STREETS AND PARKING AREAS FREE AND CLEAN OF PROJECT DIRT, MUD, AND MATERIALS DURING THE CONSTRUCTION PERIOD. THE CONTRACTOR SHALL BE RESPONSIBLE FOR CORRECTIVE MEASURES AS DIRECTED BY THE PUBLIC WORKS INSPECTOR AT NO EXPENSE TO THE CITY.
MM. A BUILDING PERMIT IS REQUIRED FOR CONSTRUCTION OF ALL RETAINING WALLS OVER 4 FEET IN HEIGHT MEASURED FROM THE BOTTOM OF THE FOOTING TO THE TOP OF THE WALL. PRIOR TO ACCEPTANCE OF THE IMPROVEMENTS AS COMPLETE, VERIFICATION THAT BUILDING INSPECTION HAS SIGNED OFF ON THE PERMIT SHALL BE PROVIDED TO THE PUBLIC WORKS INSPECTOR. ALL WOOD IN CONTACT WITH THE GROUND SHALL BE PRESSURE-TREATED, WHETHER A CONSTRUCTION PERMIT IS REQUIRED OR NOT.
NN. THE MANNER OF BRACING AND SHORING EXCAVATIONS SHALL BE AS SET FORTH IN THE RULES, ORDERS AND REGULATIONS OF THE STATE OF CALIFORNIA CONSTRUCTION SAFETY ORDERS, DIVISION OF INDUSTRIAL SAFETY.
OO. CONTRACTORS MAY BE REQUIRED AT THE DISCRETION OF THE CITY ENGINEER TO PROVIDE DRAWINGS OR CALCULATIONS BY A REGISTERED ENGINEER FIVE (5) WORKING DAYS PRIOR TO BEGINNING CONSTRUCTION FOR SPECIALLY DESIGNED BRACING AND SHORING OF AN EXCAVATION WHERE STANDARD PRE-MANUFACTURED BRACING OR SHORING CANNOT BE USED.
PP. CONTRACTORS SHALL SUBMIT A COPY OF THEIR CURRENT ANNUAL EXCAVATION PERMIT ISSUED BY THE STATE OF CALIFORNIA DIVISION OF INDUSTRIAL SAFETY (CAL-OSHA) ALONG WITH THE CONTRACTOR'S OWN TRENCH SAFETY PLAN PRIOR TO THE START OF CONSTRUCTION.
QQ. PRIOR TO ANY WORK BEING PERFORMED, THE CONTRACTOR SHALL ATTEND A PRE- CONSTRUCTION MEETING WITH THE CITY OF LATHROP. THE CONTRACTOR SHALL PROVIDE THE CITY OF LATHROP 72 HOURS' NOTICE TO SCHEDULE THE PRE-CONSTRUCTION MEETING. THE CONTRACTOR SHALL ALSO NOTIFY THE BELOW LISTED PROJECT CONTACTS A MINIMUM OF 72 HOURS IN ADVANCE OF SAID MEETING.
STORM DRAIN NOTES:
A. ALL PUBLIC STORM DRAIN LINES SHALL BE CLASS III OR HIGHER CLASS RCP OR POLYPROPYLENE PIPE TYPE "S" UP TO 36 UNLESS OTHERWISE SPECIFIED ON THE PLANS.
1. ALL PRE-CAST RCP SHALL BE OF WET CAST TYPE CONSTRUCTION. USE RUBBER GASKETED JOINTS CONFORMING TO THE REQUIREMENTS OF ASTM DESIGNATIONS C-76 AND C-443 AND SECTION 3 OF THE DESIGN AND CONSTRUCTION STANDARDS. ALTERNATIVE PIPE MATERIALS WILL BE EVALUATED ON A CASE-BY-CASE BASIS AND MUST BE PRE-APPROVED.
2. ALL POLYPROPYLENE PIPE SHALL BE DUAL WALL, TYPE "S" UP TO 36" MATERIAL FOR 12" - 36" PIPE AND FITTING PRODUCTION SHALL BE AN IMPACT MODIFIED COPOLYMER MEETING THE MATERIAL REQUIREMENTS OF ASTM F2764. FITTINGS SHALL BE BELL-AND-SPIGOT MEETING WATERTIGHT JOINT PERFORMANCE AND SHALL MEET REQUIREMENTS OF ASTM D3212. GASKETED BELL & SPIGOT CONNECTIONS SHALL UTILIZE A SPUN-ON, WELDED OR INTEGRAL BELL AND SPIGOT WITH GASKET MEETING ASTM F477.
a. INSTALLATION: POLYPROPYLENE PIPE SHALL MEET STANDARD DETAIL R-28A FOR STORM DRAIN FLEXIBLE PIPE. FITTINGS SHALL BE LAID TO FORM A CLOSED CONCENTRIC JOINT WITH ADJOINING PIPE TO AVOID SUDDEN OFFSETS OF THE FLOW LINE. PIPE SECTIONS SHALL BE JOINED IN A WAY THAT THEY MEET OR EXCEED PERFORMANCE STANDARDS FOUND IN ASTM F2764.
b. BACKFILL AND COMPACTION: FOLLOW STANDARD PLAN R-28A TO R-28D FOR FLEXIBLE PIPE FOR STORM DRAINAGE APPLICATIONS. APPROPRIATE COMPACTION METHODS SHALL BE UTILIZED IN ORDER TO UNIFORMLY COMPACT BACKFILL TO SPECIFIED DENSITIES. INAPPROPRIATE OR EXCESSIVE COMPACTION MAY DAMAGE THE PIPE AND DISTURB LINE AND GRADE. EACH LAYER SHALL BE UNIFORMLY COMPACTED WITH MECHANICAL MEANS AND GUIDELINES FOR FLEXIBLE PIPE, BEDDING, SHADING AND HAUNCH FOR FLEXIBLE PIPE SHALL BE 3/8 X DUST OR ALTERNATIVE APPROVED BY SENIOR CONSTRUCTION MANAGER.
c. STORAGE AND HANDLING: STORE PIPES AND FITTINGS IN A WAY THAT PROTECTS GASKETS FROM WEATHER. PROTECT THE BELL END OF PIPES FROM DAMAGE. IF STACKED, TAKE MEASURES TO ENSURE LOWER PIPES ARE NOT DAMAGED FROM EXCESSIVE WEIGHT. COVER PIPES TO PROVIDE TEMPORARY SUN BLOCK, DO NOT STORE GASKETS NEAR ELECTRICAL OR EXHAUST HEAT SOURCES.

STORM DRAIN NOTES CONTINUED:

- d. THE CITY WILL REJECT PIPES WITH CRACKS OR SPLITS GASKETS.
B. UNLESS NOTED OTHERWISE, ALL STORM DRAIN MANHOLES ARE TYPE I (PER STD. DETAIL D-10) AND ALL CURB INLETS SHALL BE TYPE I INLETS (SEE STD. DETAIL D-6A) OR TYPE II (SEE STD. DETAIL D-7). "SANTA ROSA" STYLE INLETS, WHICH HAVE A GRATELESS INLET, SHALL ONLY BE USED WITH APPROVAL FROM THE CITY ENGINEER. A SADDLE MANHOLE (SEE STANDARD DETAIL D-12) SHALL BE USED FOR ALL PIPES GREATER THAN 24" IN DIAMETER.
C. ALL STORM DRAIN INLETS SHALL BE LABELED PER STANDARD DETAIL D-6B "NO DUMPING - FLOWS TO RIVER" USING AN APPROVED METHOD.
D. STORM DRAIN CONSTRUCTION, MATERIALS AND WORKMANSHIP SHALL BE IN ACCORDANCE WITH THE REQUIREMENTS OF SECTION 3 OF THE DESIGN AND CONSTRUCTION STANDARDS AND THE STANDARD DETAILS.
E. THE CONTRACTOR IS TO BE RESPONSIBLE FOR ALL TESTING OF STORM DRAIN FACILITIES. CONTRACTOR SHALL CLEAN, FLUSH AND PROVIDE VIDEO INSPECTION OF ALL STORM DRAIN LINES TO THE SATISFACTION OF THE PUBLIC WORKS INSPECTOR.
F. ALL FIELD INLETS TO BE TYPE 1 INLETS WITH FLAT GRATE PER CITY STANDARD D-6A.

STREET NOTES:

- A. PRIOR TO PLACING CURB AND GUTTER, SIDEWALK, ASPHALT CONCRETE, SUBBASE, OR BASE MATERIAL, ALL UNDERGROUND FACILITIES WITHIN THE RIGHT-OF-WAY SHALL BE INSTALLED, BACKFILL COMPLETED, AND THE PUBLIC WORKS DEPARTMENT CONSTRUCTION INSPECTION DIVISION NOTIFIED THAT THE UTILITY INSTALLATION HAS SATISFACTORILY PASSED ACCEPTANCE TESTS BY EACH OF THE UTILITY COMPANIES HAVING FACILITIES WITHIN THE WORK AREAS.
B. WHEN WIDENING THE PAVEMENT ON AN EXISTING ROAD, THE EXISTING PAVEMENT SHALL BE SAW CUT TO A NEAT LINE, NOT LOCATED IN THE WHEEL PATH OF VEHICLE TRAFFIC, AND REMOVED BACK TO AN EXISTING SOUND STRUCTURAL SECTION AS DETERMINED BY THE CITY ENGINEER. AN EXPLORATORY TRENCH, OR POT-HOLING, MAY BE REQUIRED TO DETERMINE THE LIMITS OF PAVEMENT REMOVAL.
C. STREET STRIPING SHALL INCLUDE STOP BARS, CENTERLINE STRIPING OR MARKERS, CROSSWALKS AND ALL OTHER MARKINGS REQUIRED BY THE CITY ENGINEER. ALL STRIPING SHALL BE DONE WITH THERMOPLASTIC AND REFLECTIVE MARKERS. ALL STRIPING SHALL BE CAT-TRACKED PRIOR TO FINAL INSTALLATION. FINAL INSTALLATION OF STRIPING WILL BE ALLOWED ONLY AFTER APPROVAL OF THE STRIPING LAYOUT BY THE CONSTRUCTION INSPECTOR.
D. THE THICKNESS OF SUBBASE, BASE, AND SURFACING SHALL BE AS APPROVED ON THESE PLANS.
E. FOG SEAL OF ASPHALTIC CONCRETE. THE TYPE OF FOG SEAL USED SHALL BE PER SECTION 37 OF CALTRANS STANDARD SPECIFICATIONS LATEST EDITION AND APPROVED BY THE CITY OF LATHROP PRIOR TO USE.
F. OMITTED.
G. ALL TERMINATED STREETS WITHOUT CUL-DE-SACS SHALL HAVE A BARRICADE INSTALLED IN ACCORDANCE WITH STANDARD DETAIL R-24 OF THE STANDARD DETAILS.
H. ALL MANHOLE RIMS, LAMPHOLES, VALVES, AND MONUMENT BOXES, ETC. SHALL BE ADJUSTED TO FINISH GRADE AFTER STREET PAVING BY THE UNDERGROUND CONTRACTOR AFTER THE FINAL PAVING COURSE IS PLACED, UNLESS OTHERWISE NOTED. COST FOR THIS WORK SHALL BE INCLUDED IN THE UNIT PRICES FOR MANHOLES.
I. THE CONTRACTOR SHALL PROTECT ALL EXISTING MONUMENTS AND HAVE THE ENGINEER/LAND SURVEYOR TIE OUT BEFORE THE SETTING OF ALL NEW MONUMENTS. ALL SURVEY MONUMENT WELLS SHALL BE FURNISHED AND INSTALLED BY THE CONTRACTOR AT LOCATIONS SHOWN. DEVELOPER'S ENGINEER/LAND SURVEYOR SHALL SET AND STAMP ALL MONUMENTS AND FURNISH THE CITY ENGINEER WITH A COPY OF A TIE PLAT FOR EACH MONUMENT.
J. THE CONTRACTOR SHALL BE RESPONSIBLE FOR THE PROTECTION OF ALL EXISTING MONUMENTS AND/OR OTHER SURVEY MONUMENTS AND SHALL NOTIFY THE CITY ENGINEER OF ANY DAMAGED OR REMOVED CITY, COUNTY, STATE OR FEDERAL MONUMENTS.
IF A MONUMENT IS LOCATED WITHIN THE BOUNDARY OF THE PROJECT, THE CONTRACTOR SHALL SUBMIT THE ACKNOWLEDGEMENT OF MONUMENT RESPONSIBILITY "PRE- CONSTRUCTION" FORM, FOUND IN APPENDIX E OF THE CITY OF LATHROP STANDARDS, TO THE CITY DURING THE ENCROACHMENT PERMIT APPLICATION PHASE. IN ADDITION, THE CONTRACTOR SHALL SUBMIT THE ACKNOWLEDGEMENT OF MONUMENT RESPONSIBILITY "POST-CONSTRUCTION" FORM, FOUND IN APPENDIX E OF THESE STANDARDS, TO THE CITY WHEN THE WORK IS COMPLETE.
K. UTILITY BOXES SET IN PAVED STREETS SHALL HAVE H-20 TRAFFIC RATING LIDS.

SPECIAL NOTES:

- A. EXISTING STREETS THAT REQUIRE RECONSTRUCTION AS A RESULT OF THE CONSTRUCTION TRAFFIC SHALL REMAIN OPEN AT ALL TIMES WITH ADEQUATE DETOURS DURING RECONSTRUCTION. RECONSTRUCTION OF EXISTING STREETS SHALL INCLUDE UPGRADING THE AFFECTED PAVEMENT AREA TO MEET ORIGINAL STANDARDS TO PROVIDE A SOUND STRUCTURAL SECTION. THE CITY ENGINEER SHALL APPROVE ALL IMPROVEMENTS.
B. ANY EXISTING IMPROVEMENTS THAT ARE DAMAGED DURING CONSTRUCTION SHALL BE REMOVED, REPLACED, AND FULLY RESTORED TO ITS' ORIGINAL CONDITION AT THE DEVELOPER'S COST. ALL WORK SHALL BE APPROVED BY THE CITY ENGINEER.
C. DEVELOPER/CONTRACTORS WORK SHALL BE IN ACCORDANCE WITH THE SJVAPCD GUIDELINES, INCLUDED SJVAPCD REGULATION VIII AND IMPLEMENT CONTROL MEASURES BASED ON SJVAPCD COMPLIANCE ASSISTANCE BULLETIN FOR SHORT TERM IMPACTS, SJVAPCD SHALL BE CONTACTED TO DISCUSS MITIGATION MEASURES AND IMPLEMENT MEASURES FROM TABLE 6-4 OF THE GUIDE FOR ASSESSING AND MITIGATION AIR QUALITY IMPACTS.
D. ALL PRESSURIZED PLASTIC PIPES SHALL HAVE TRACE WIRES.
E. DEWATERING PLANS FOR ALL TRENCHES SHALL BE SUBMITTED FOR APPROVAL BY THE CITY ENGINEER.
F. ALL IRRIGATION SYSTEMS WITH THE CITY'S RIGHT-OF-WAYS OR PARKS SHALL BE DESIGNED USING "CALSENSE" CONTROLLERS AS APPROVED BY THE CITY ENGINEER.
G. ALL DUCTILE IRON PIPE AND FITTINGS SHALL BE WRAPPED IN POLYWRAP.

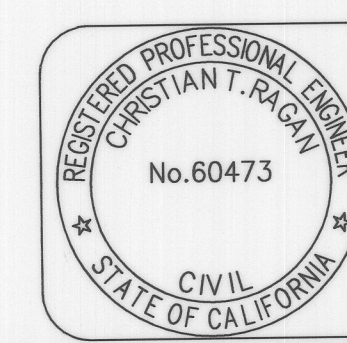

RECORD DRAWING

THESE ARE THE FINAL CONSTRUCTION PLANS FOR THE PROJECT WITH THE ADDITIONS NOTED FOR FIELD CHANGES BROUGHT TO THE ATTENTION OF THE ENGINEER BY THE DEVELOPER, CONTRACTOR, AND THE CITY INSPECTOR.

CHRISTIAN T. RAGAN RCE #60473

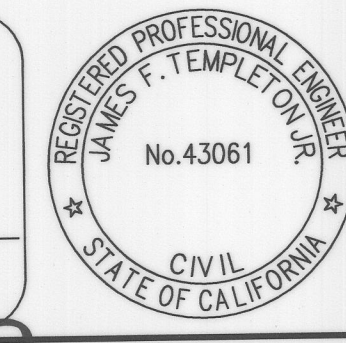

PLANS PREPARED UNDER THE DIRECTION OF: [Signature] RCE #43061

Table with 4 columns: NO., DESCRIPTION, CHECKED BY, CITY APPROVAL (APPROVED BY, DATE). Includes a REVISIONS column on the left.



LATHROP GENERATIONS CENTER PARKING LOT GENERAL NOTES DEPARTMENT OF PUBLIC WORKS CITY OF LATHROP, CALIFORNIA. Includes project info: FEBRUARY 2020, SCALE: AS NOTED, SHEET NO. 25227.010, C2, SHEET 2 OF 8.

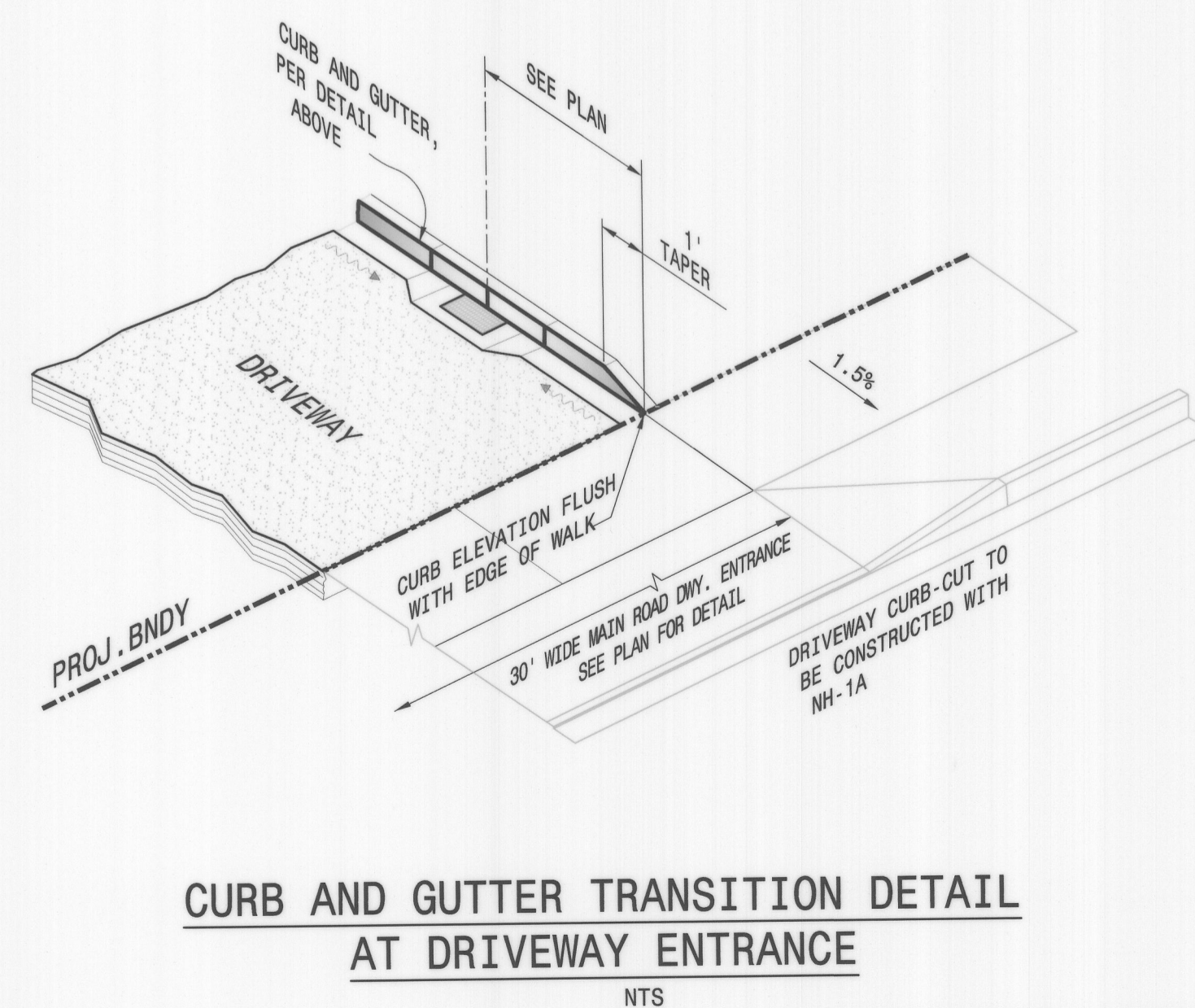
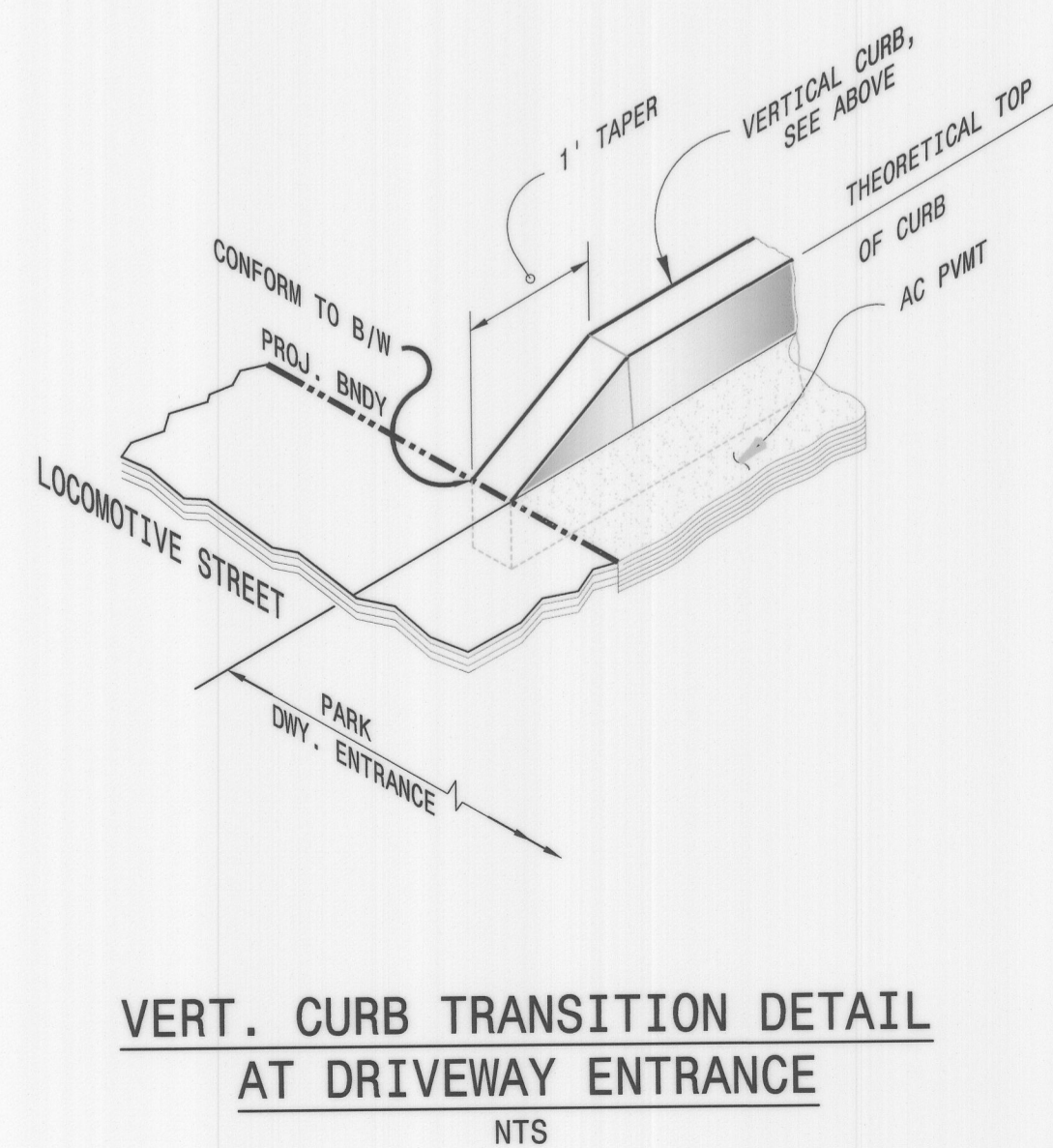
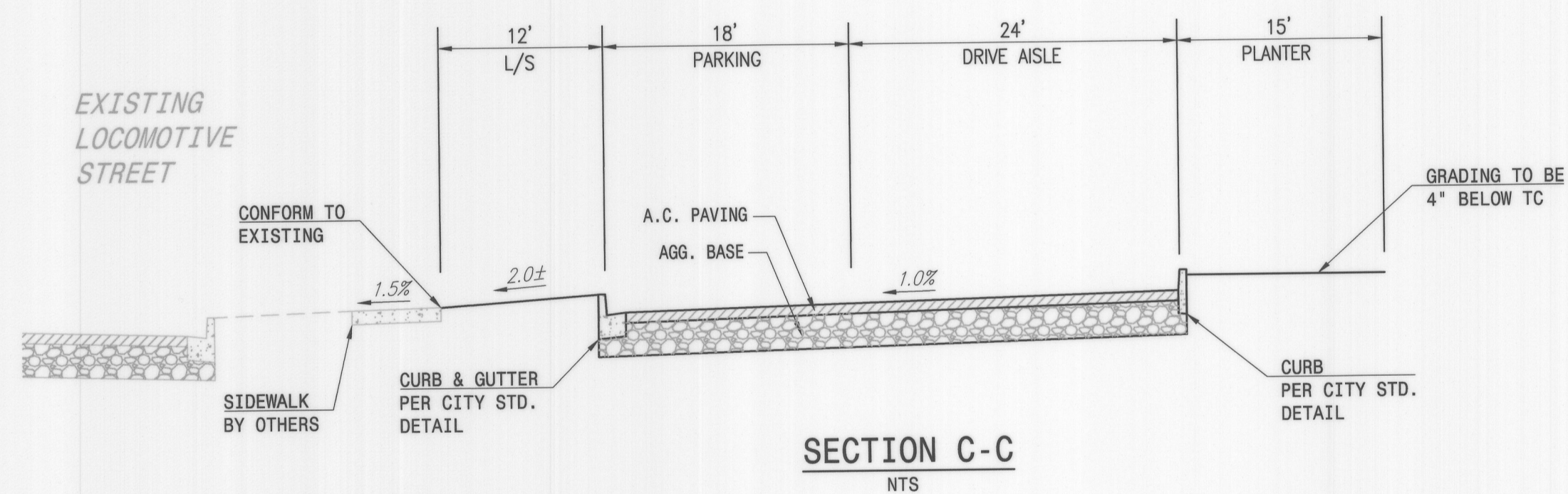
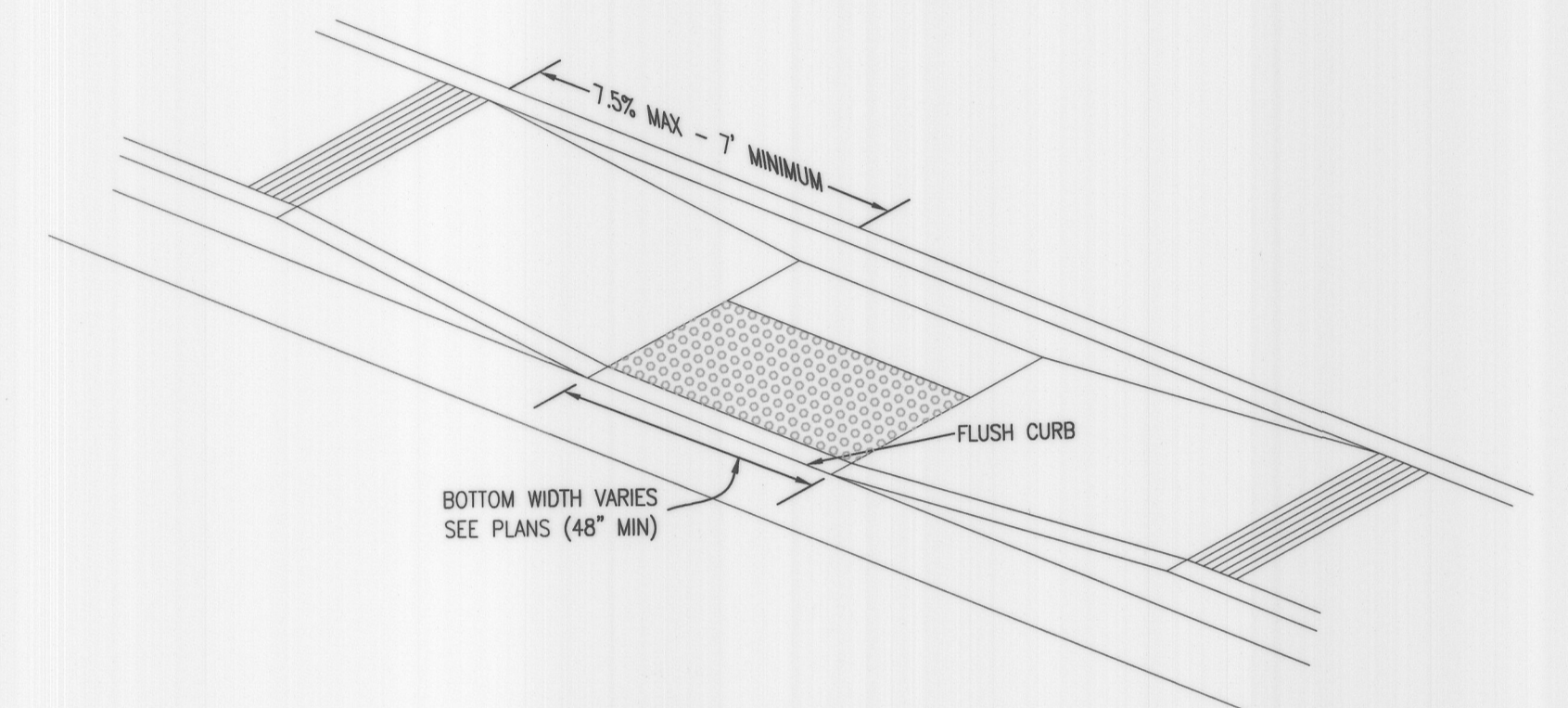
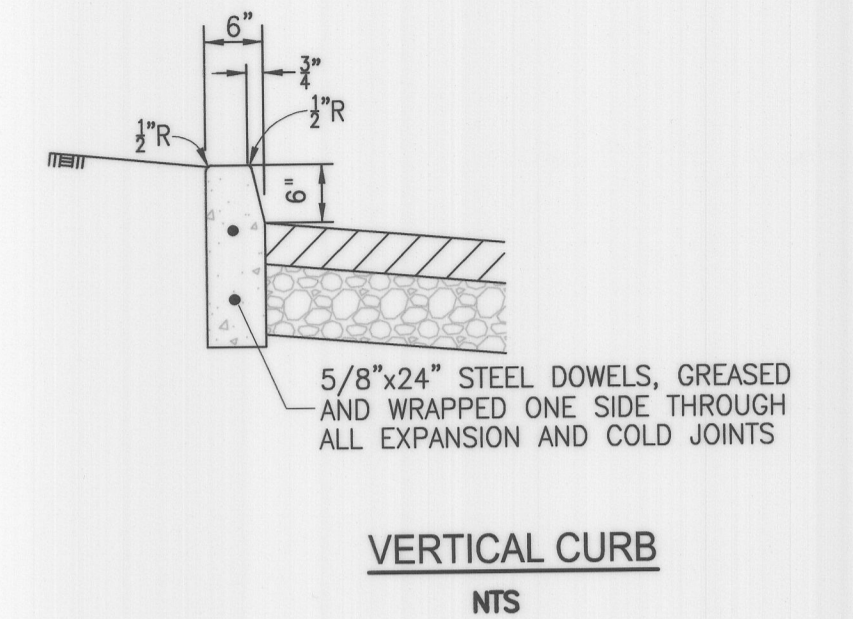
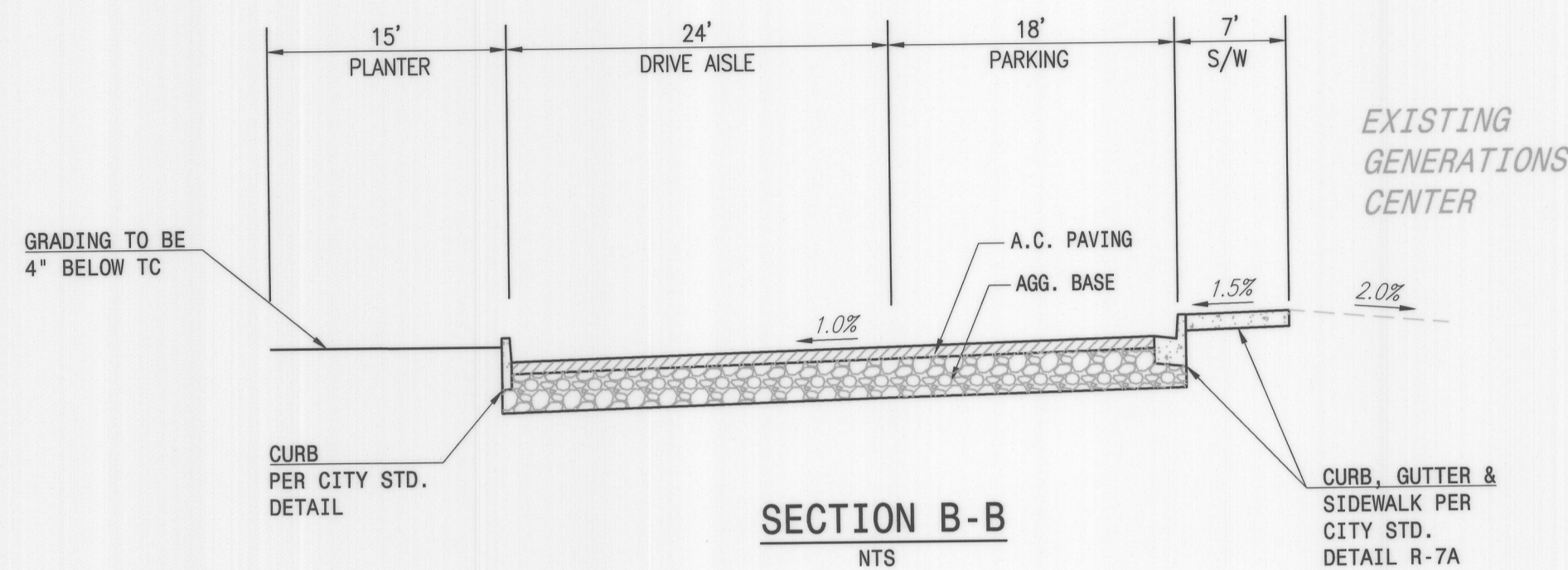
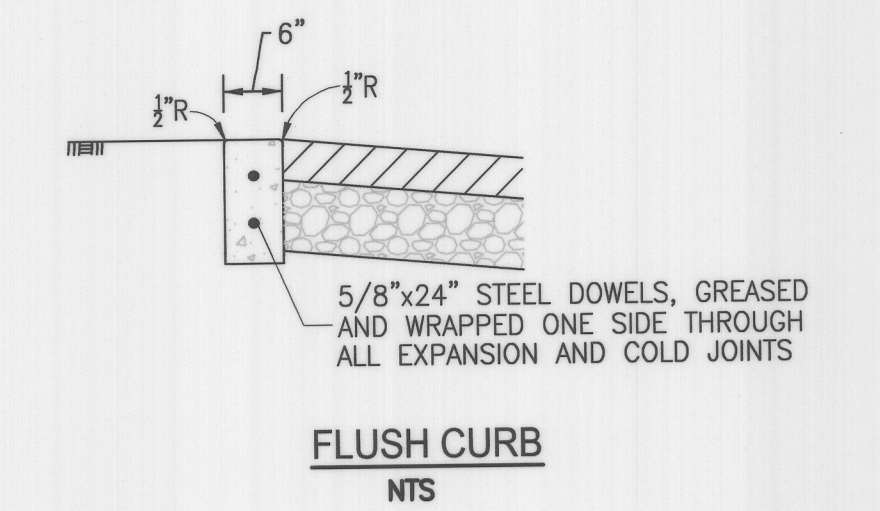
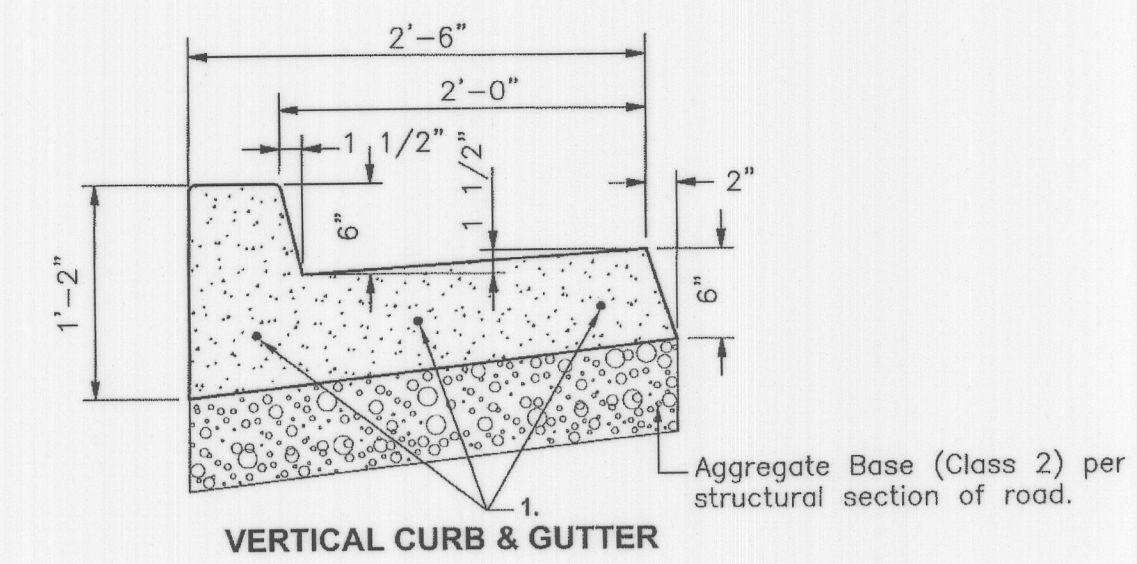
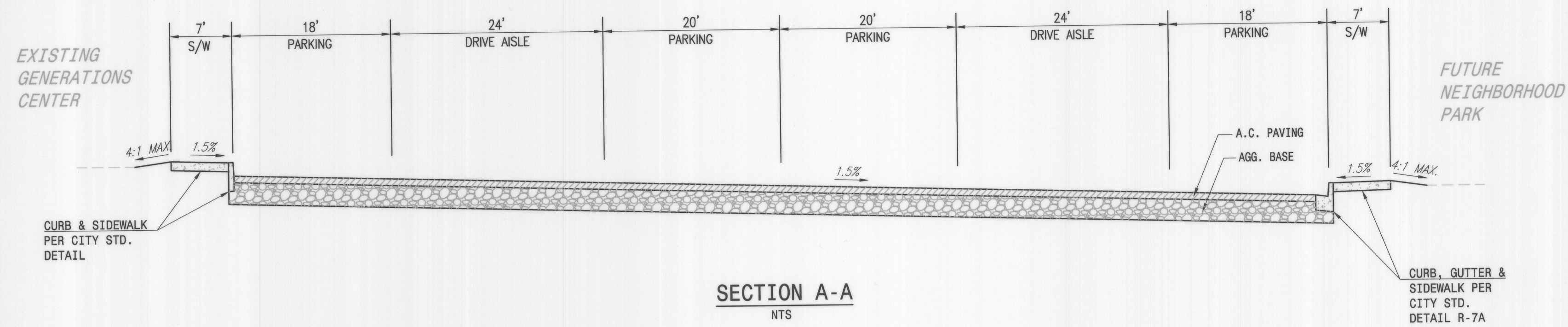

PAVEMENT SECTIONS			
AREA	T.I.	AC	AB
PARKING LOT	5.0	3.0"AC	6.0"AB

NOTE: PAVEMENT SECTION AS SPECIFIED BY CITY OF LATHROP.

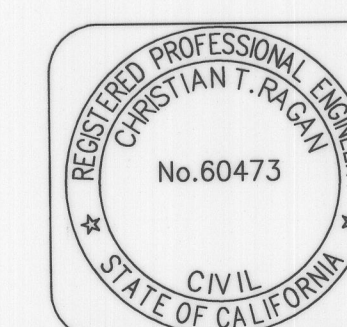

RECORD DRAWING

THESE ARE THE FINAL CONSTRUCTION PLANS FOR THE PROJECT WITH THE ADDITIONS NOTED FOR FIELD CHANGES BROUGHT TO THE ATTENTION OF THE ENGINEER BY THE DEVELOPER, CONTRACTOR, AND THE CITY INSPECTOR.

CHRISTIAN T. RAGAN
RCE #60473



PLANS PREPARED UNDER THE DIRECTION OF:
BY: JAMES F. TEMPLETON JR., RCE #43061

LATHROP GENERATIONS CENTER
PARKING LOT
DETAILS AND SECTIONS

DEPARTMENT OF PUBLIC WORKS
CITY OF LATHROP, CALIFORNIA

DATE: FEBRUARY 2020	RECOMMENDED FOR APPROVAL BY:	DATE:	PROJECT NO. 25227.010
SCALE: AS NOTED	DESIGNED BY: JFT	CHECKED BY: JFT	SHEET NO. C3
			SHEET 3 OF 8

NO.	DESCRIPTION	CHECKED BY	CITY APPROVAL	DATE

Mackay & Somp
ENGINEERS PLANNERS SURVEYORS
PLEASANTON, CA (925)225-0690

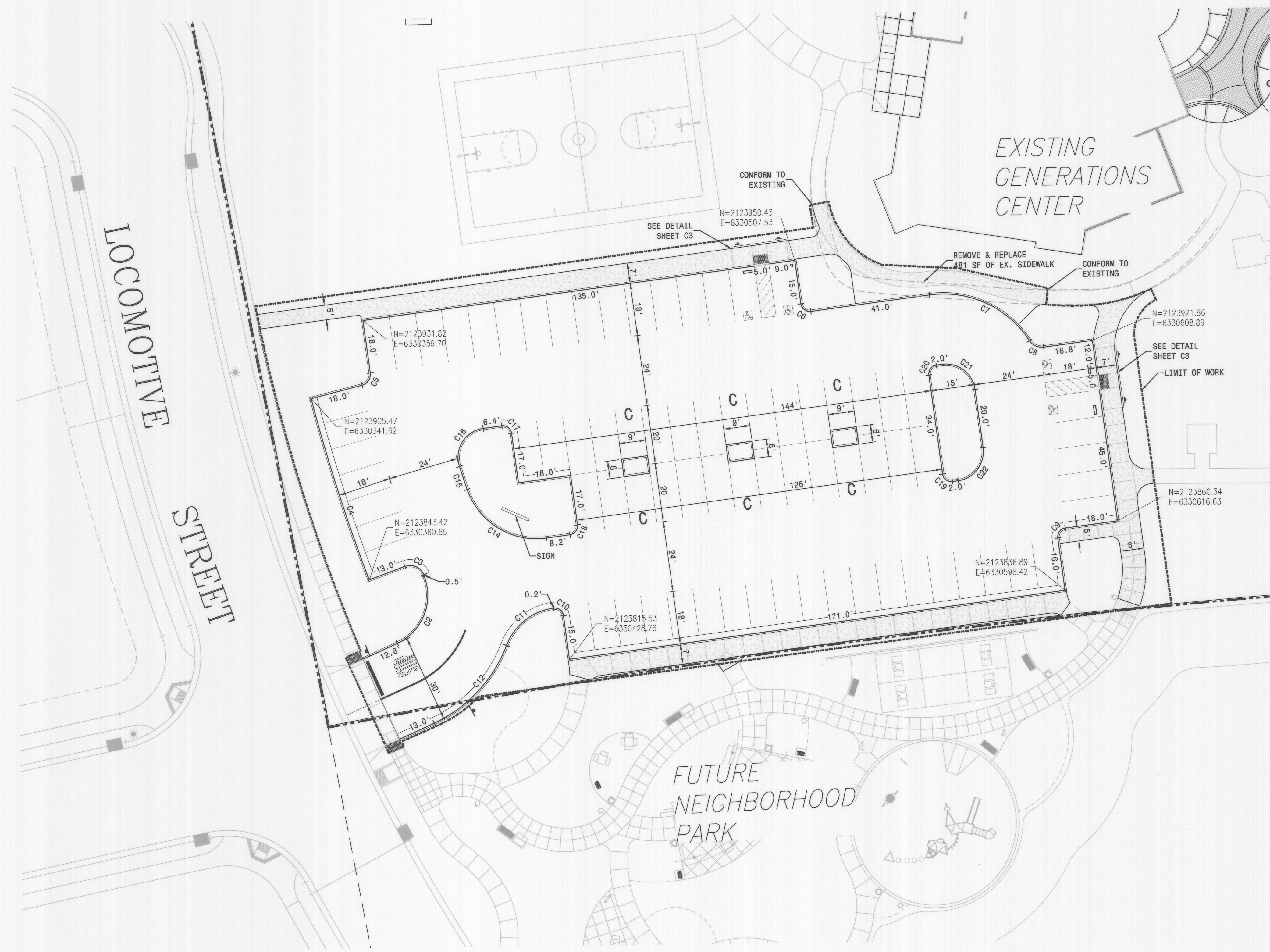
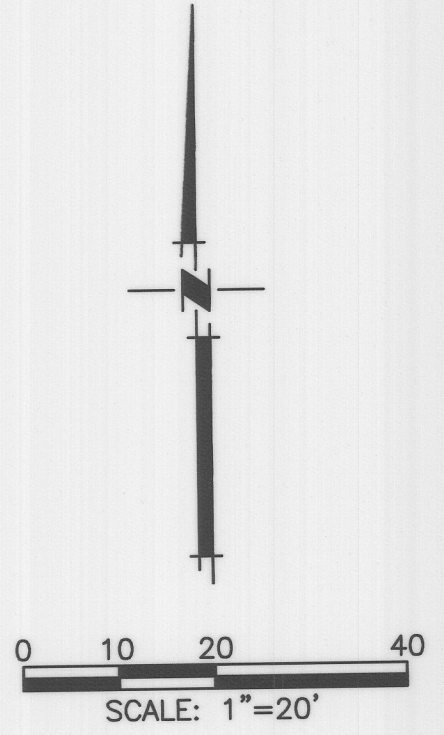

Curve Table			
Curve #	Radius	Delta	Length
C2	18.00'	86°29'58"	27.17'
C3	5.00'	89°31'01"	7.81'
C4	606.00'	6°08'20"	64.93'
C5	3.78'	83°22'37"	5.51'
C6	3.00'	90°00'00"	4.71'
C7	35.00'	64°50'58"	39.61'
C8	5.00'	64°50'58"	5.66'
C9	3.00'	90°00'00"	4.71'
C11	20.00'	61°17'11"	21.39'
C12	48.00'	44°18'19"	37.12'
C14	25.00'	78°46'25"	34.37'
C16	10.00'	100°23'33"	17.52'
C17	3.00'	90°00'00"	4.71'
C18	3.00'	90°00'00"	4.71'
C19	3.00'	90°00'00"	4.71'
C21	10.00'	90°00'00"	15.71'
C22	10.00'	90°00'00"	15.71'

RECORD DRAWING
 THESE ARE THE FINAL CONSTRUCTION PLANS FOR THE PROJECT WITH THE ADDITIONS NOTED FOR FIELD CHANGES BROUGHT TO THE ATTENTION OF THE ENGINEER BY THE DEVELOPER, CONTRACTOR, AND THE CITY INSPECTOR.

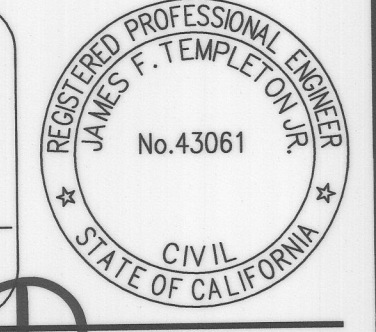
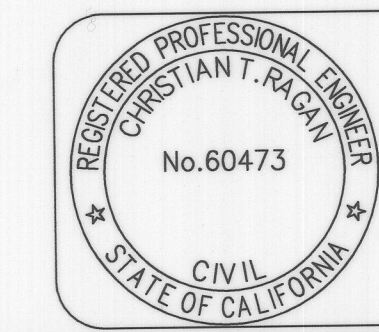

LATHROP GENERATIONS CENTER
 PARKING LOT
HORIZONTAL CONTROL PLAN
 DEPARTMENT OF PUBLIC WORKS
 CITY OF LATHROP, CALIFORNIA

NO.	DESCRIPTION	CHECKED BY	CITY APPROVAL	
			APPROVED BY	DATE

Mackay & Somp
 ENGINEERS PLANNERS SURVEYORS
 PLEASANTON, CA (925)225-0890

PLANS PREPARED UNDER THE DIRECTION OF:
 BY: JAMES F. TEMPLETON JR. RCE #43061

DATE: FEBRUARY 2020
 SCALE: AS NOTED
 DRAWN BY: RH
 DESIGNED BY: JFT
 CHECKED BY: JFT

RECOMMENDED FOR APPROVAL BY: _____ DATE: _____

PROJECT NO. 25227.010
 SHEET NO. C4
 SHEET 4 OF 8

WARNING • CAUTION
 EXISTING UNDERGROUND UTILITIES
 CONTACT: UNDERGROUND SERVICE ALERT
 PHONE: (800) 227-2600
 FOR MARKING PRIOR TO DIGGING

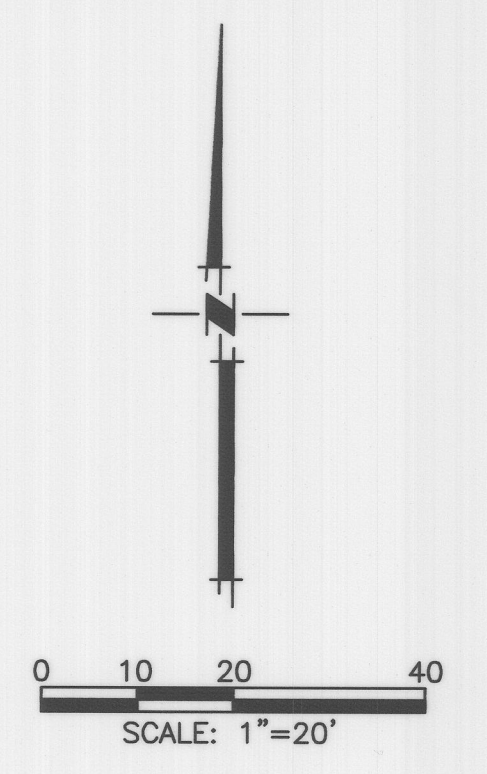
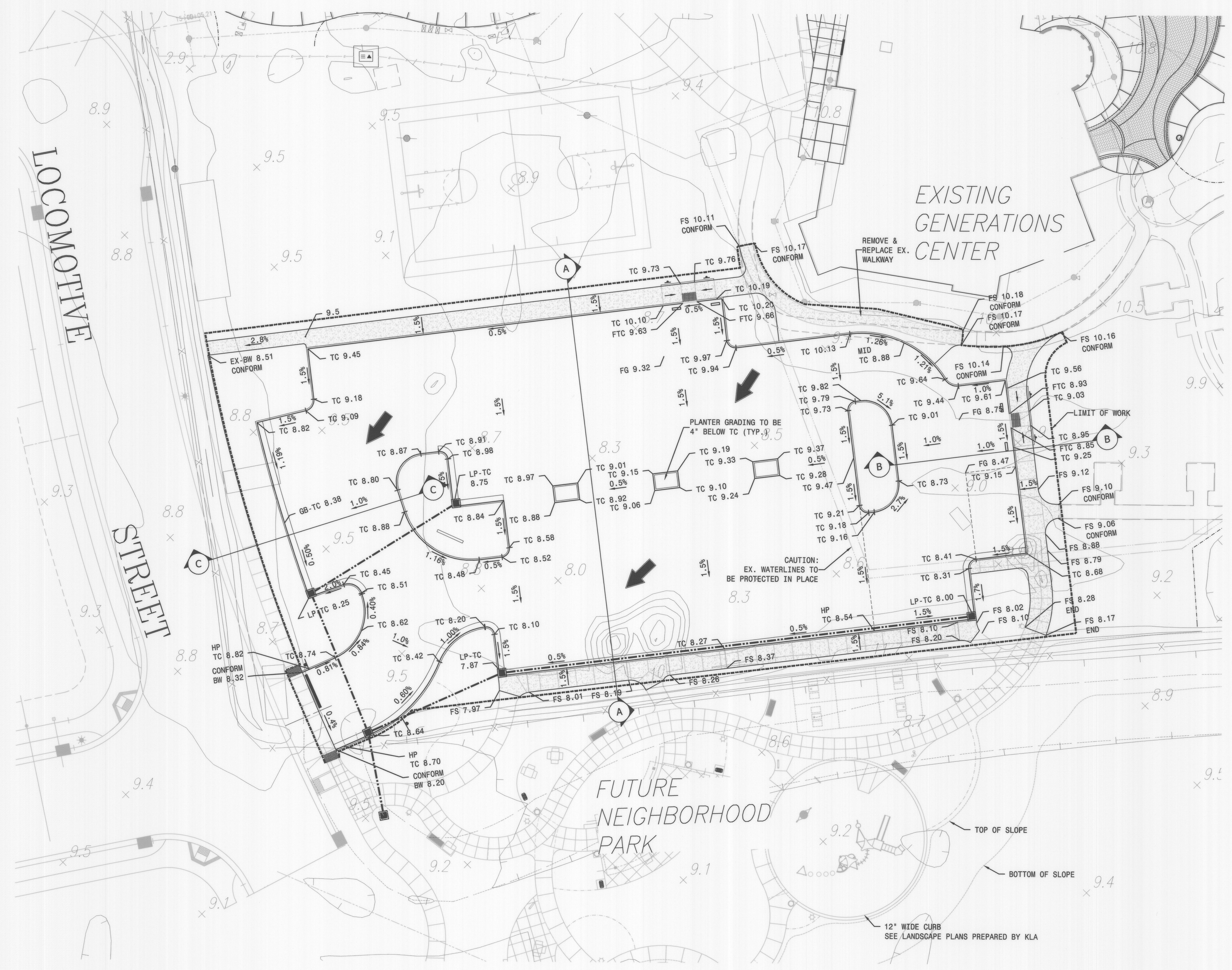

EARTHWORK SUMMARY:
 THE EARTHWORK SUMMARY IS PROVIDED AS A COURTESY AND CONVENIENCE TO THE CONTRACTOR. THE EXCESSES AND SHORTAGES SHOWN ARE APPROXIMATE CALCULATED QUANTITIES BASED ON THE DIFFERENCES BETWEEN EXISTING GROUND ELEVATIONS AND FINISH ROUGH GRADE ELEVATIONS. THE CALCULATION MAKES NO PROVISION FOR STRIPPING OR SUBEXCAVATION. FOR THIS REASON AND BECAUSE OF VARIABLES SUCH AS COMPACTION, SHRINKAGE AND THE CONTRACTOR'S METHOD OF OPERATION, THE VOLUME OF DIRT MOVED IN THE FIELD WILL IN ALL LIKELIHOOD DEVIATE TO SOME EXTENT FROM THE CALCULATED VOLUME. THE EARTHWORK SUMMARY DOES NOT RELIEVE THE CONTRACTOR OF HIS RESPONSIBILITY REQUIRED TO DETERMINE FOR HIMSELF THE QUANTITY OF EARTHMOVING THAT WILL BE REQUIRED TO ROUGH GRADE THIS JOB. IT IS UNDERSTOOD THAT THE CONTRACTOR'S BID PRICE FOR ROUGH GRADING THIS JOB IS BASED ON THE CONTRACTOR'S OWN EARTHWORK ESTIMATE AND INCLUDES PROVISION FOR ANY GRADE ADJUSTMENTS REQUIRED TO BRING THE JOB TO A FINISH ROUGH GRADE CONDITION.

AREA	ESTIMATED FILL (CY)	ESTIMATED CUT (CY)
ROUGH GRADING - ONSITE	0	1,160
ON-SITE TRENCH SPOILS		100
TOTALS	0	1,260
	EXCESS MATERIAL	1,260 CY

NOTE: EXCESS MATERIAL TO BE OFF-HAULED PER DIRECTION BY CITY.

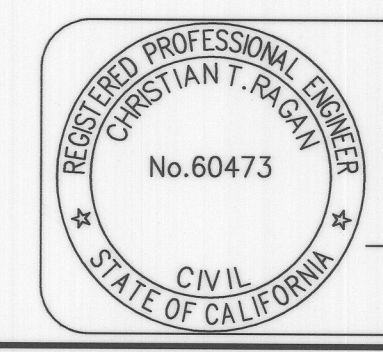

RECORD DRAWING
 THESE ARE THE FINAL CONSTRUCTION PLANS FOR THE PROJECT WITH THE ADDITIONS NOTED FOR FIELD CHANGES BROUGHT TO THE ATTENTION OF THE ENGINEER BY THE DEVELOPER, CONTRACTOR, AND THE CITY INSPECTOR.
 CHRISTIAN T. RAGAN
 RCE #60473

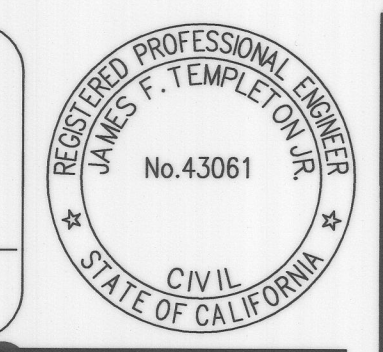

LATHROP GENERATIONS CENTER
 PARKING LOT
GRADING PLAN & SITEWORK PLAN
 DEPARTMENT OF PUBLIC WORKS
 CITY OF LATHROP, CALIFORNIA

DATE: FEBRUARY 2020	RECOMMENDED FOR APPROVAL BY: _____	PROJECT NO. 25227.010
SCALE: AS NOTED	DATE: _____	SHEET NO. C5
DRAWN BY: JFT		
DESIGNED BY: JFT		
CHECKED BY: JFT		

NO.	DESCRIPTION	CHECKED BY	CITY APPROVAL APPROVED BY DATE

Mackay & Somp
 ENGINEERS PLANNERS SURVEYORS
 PLEASANTON, CA (925)225-0990

PLANS PREPARED UNDER THE DIRECTION OF:
 BY: JAMES F. TEMPLETON, RCE #43061

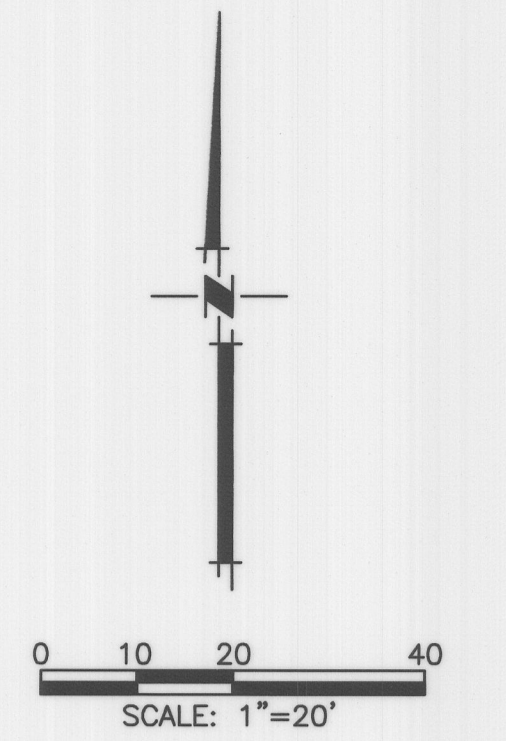
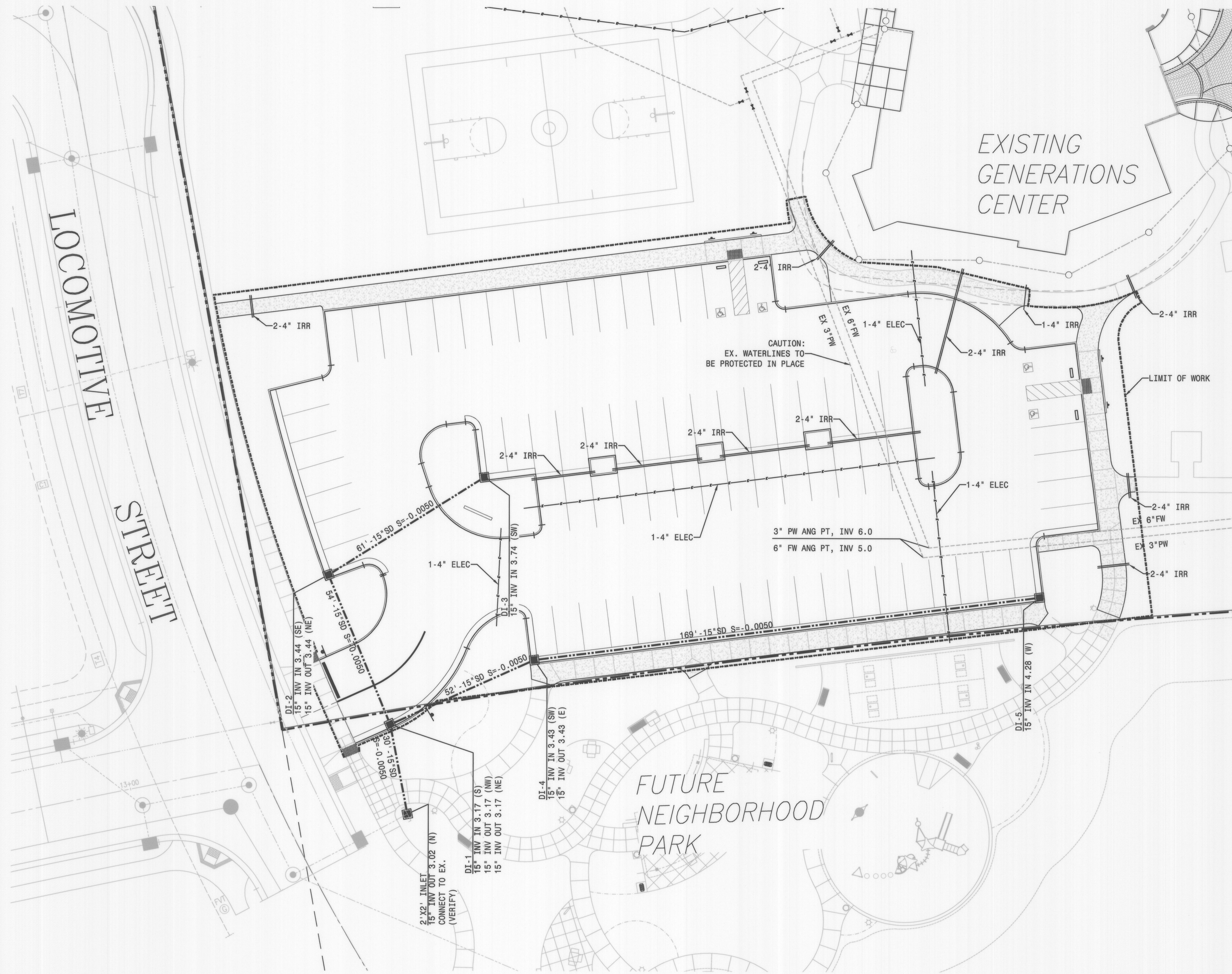

NOTE:
SLEEVES SHALL BE SCH. 40 PVC PIPE

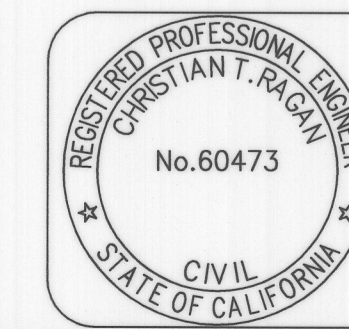

RECORD DRAWING
THESE ARE THE FINAL CONSTRUCTION PLANS FOR THE PROJECT WITH THE ADDITIONS NOTED FOR FIELD CHANGES BROUGHT TO THE ATTENTION OF THE ENGINEER BY THE DEVELOPER, CONTRACTOR, AND THE CITY INSPECTOR.
CHRISTIAN T. RAGAN
RCE #60473

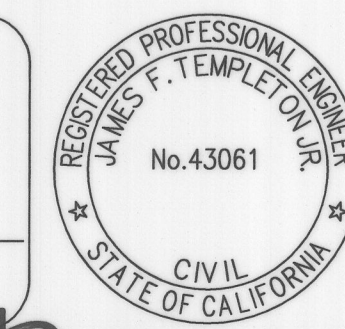

LATHROP GENERATIONS CENTER
PARKING LOT
UTILITY PLAN
DEPARTMENT OF PUBLIC WORKS
CITY OF LATHROP, CALIFORNIA

NO.	DESCRIPTION	CHECKED BY	CITY APPROVAL	
			APPROVED BY	DATE

Mackay & Somp
ENGINEERS PLANNERS SURVEYORS
PLEASANTON, CA (925)225-9690

PLANS PREPARED UNDER THE DIRECTION OF:
BY: *[Signature]* RCE #43061

DATE: FEBRUARY 2020	PROJECT NO. 25227.010
SCALE: AS NOTED	SHEET NO. C6
DRAWN BY: RH	
DESIGNED BY: JFT	
CHECKED BY: JFT	SHEET 6 OF 8

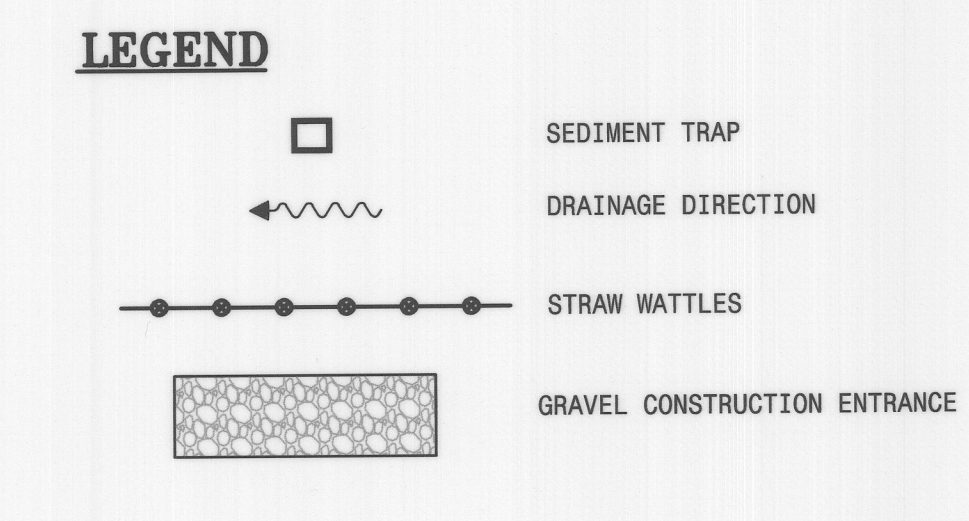
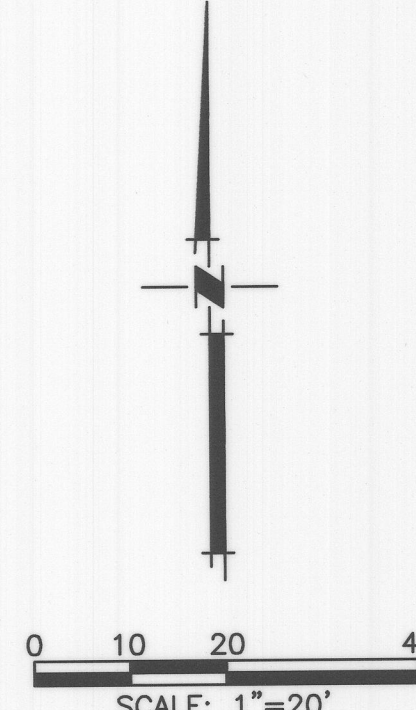
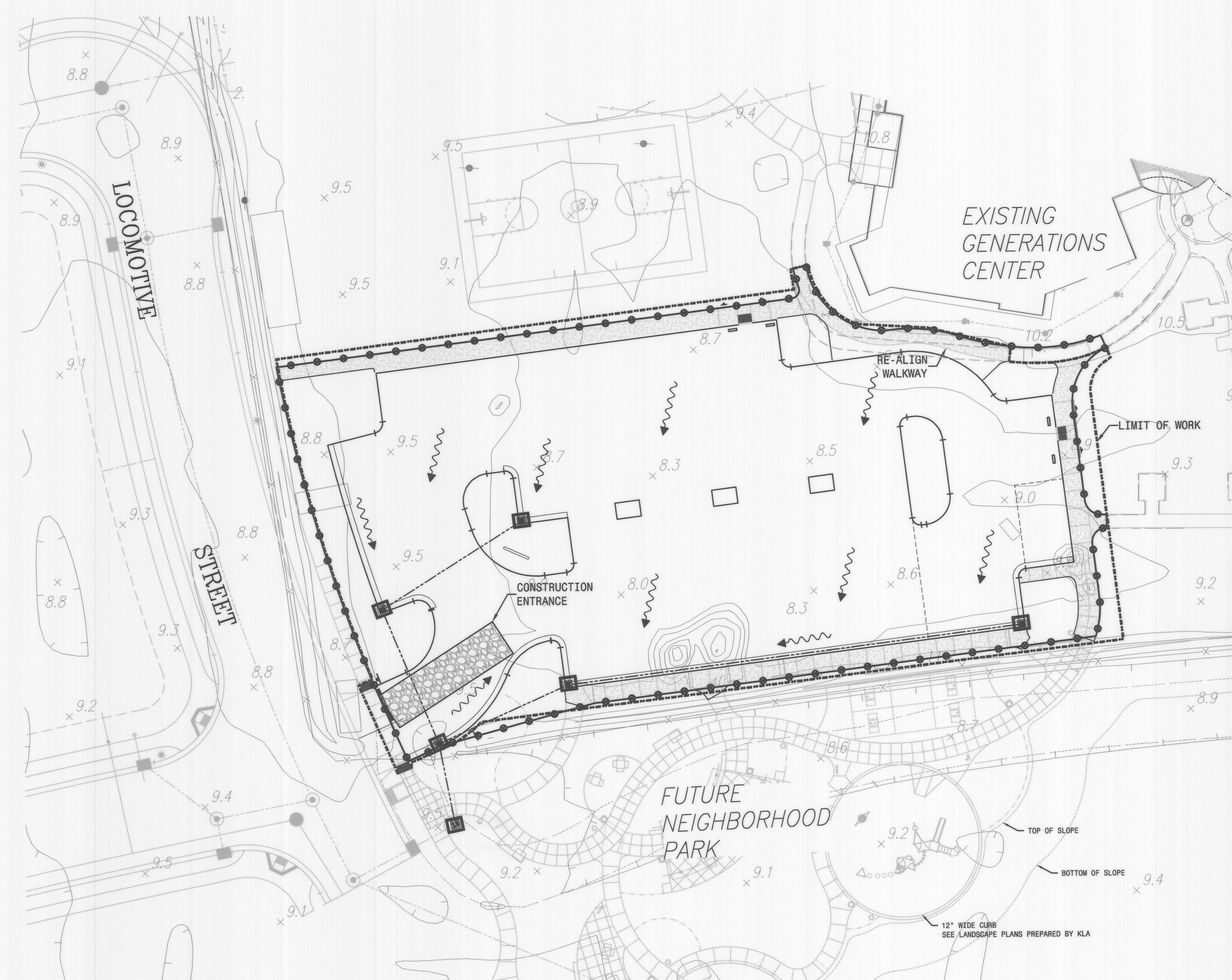
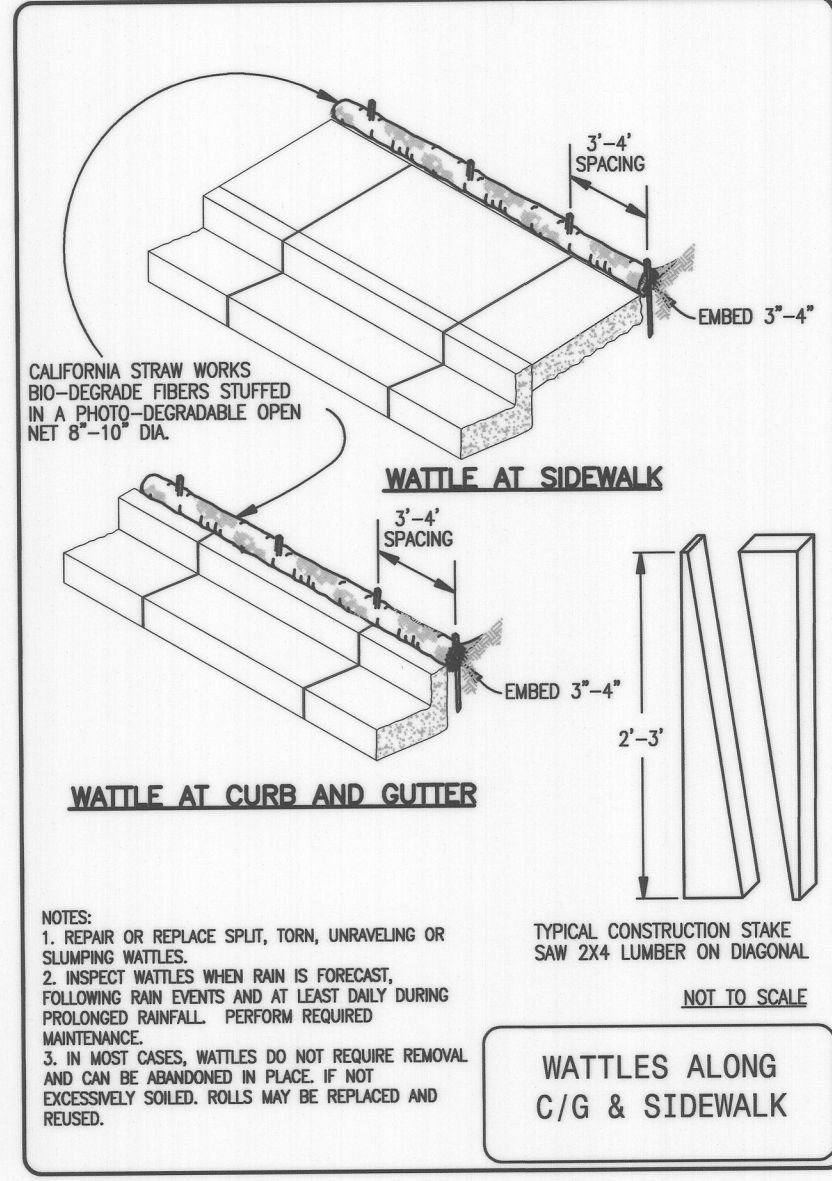
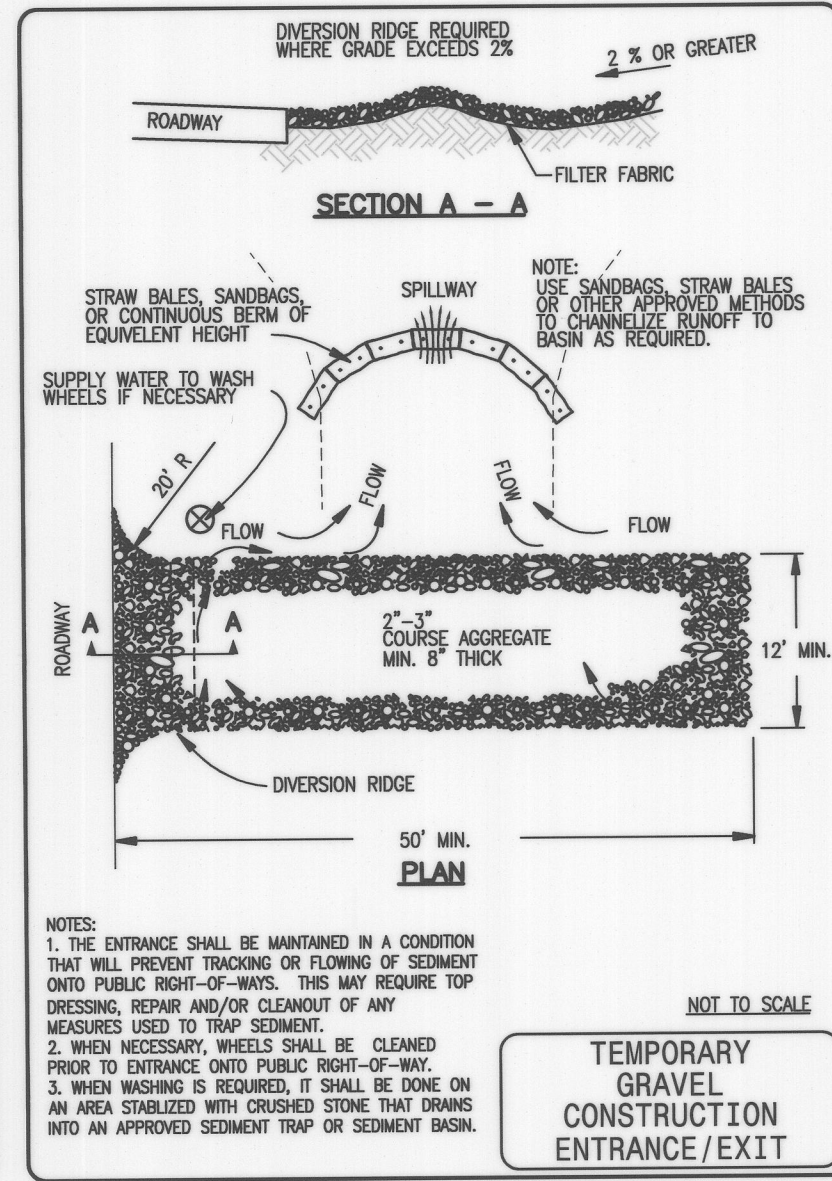
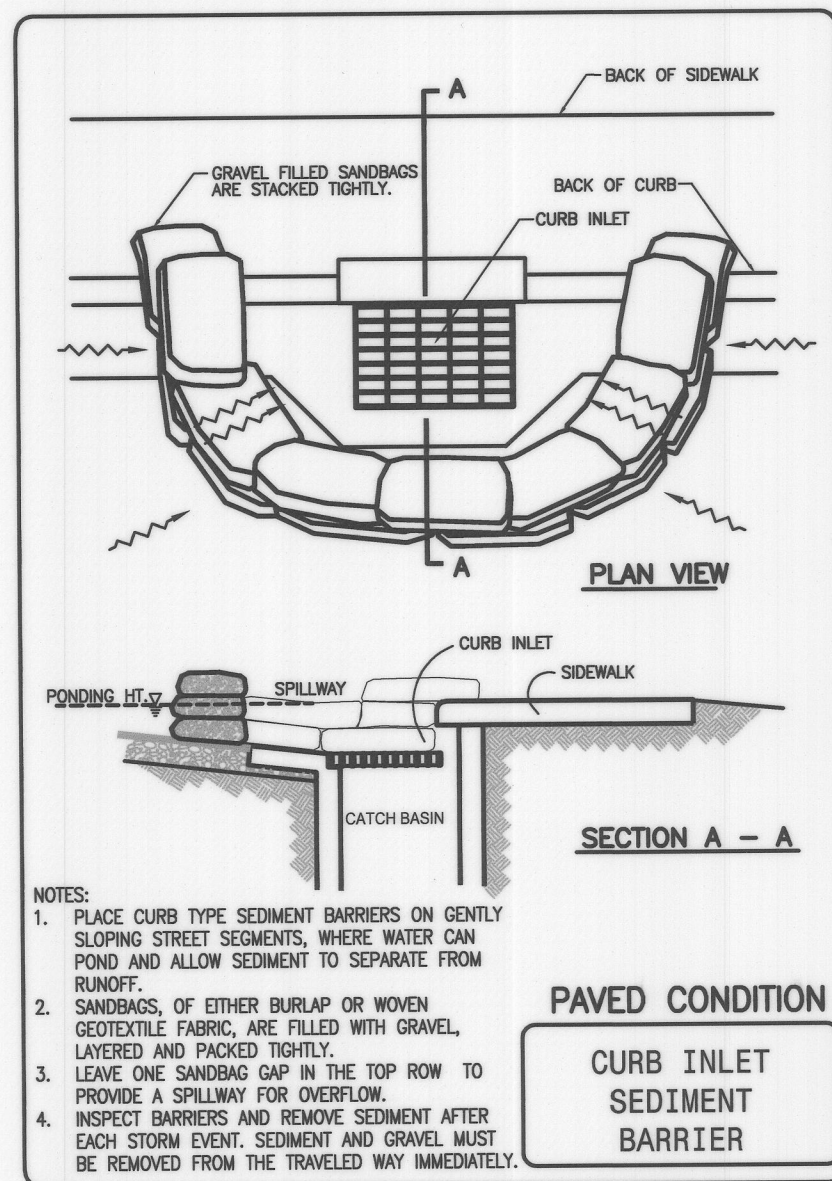

NOTE:
 THESE PLANS ARE TO BE USED ONLY FOR CONSTRUCTION OF EROSION CONTROL FACILITIES. THE GRADING INFORMATION SHOWN HEREON IS PRELIMINARY AND SUBJECT TO CHANGE. REFER TO THE ROUGH GRADE PLANS FOR GRADING INFORMATION.

- Erosion Control Notes**
- State Construction General Permit (2009-0009-DWQ effective July 1, 2010):
 - This Erosion Control Plan has been prepared to meet the local public agency grading permit requirements only. Under the State Construction General Permit, a Storm Water Pollution Prevention Plan (SWPPP) must be prepared by a qualified SWPPP Developer (QSD) who will direct the requirements for compliance with the State's general construction permit as governed by the local agency. This erosion control plan is intended to be incorporated into the required SWPPP and updated accordingly based on the recommendations of the QSD or Qualified SWPPP Practitioner (QSP) as directed in the field, whose direction will supersede this plan accordingly.
 - A Waste Discharge Identification (WDID) Number, and the SWPPP should be stored at the construction site. The SWPPP shall be maintained and updated throughout the duration of the project and shall be readily available to City and State inspectors and updated to reflect current site conditions during construction. The construction permit can be downloaded at: www.waterboards.ca.gov/water_issues/programs/stormwater
 - Field conditions may vary and alternative Erosion and Sediment Controls (ESC) and Best Management Practices (BMPs) may be required. This plan shall be modified by the QSD / QSP to account for actual field conditions.
 - Any revisions to the approved plans submitted to the state board shall be downloaded onto the state boards smart database by the LRP or their designee.
 - Runoff: All runoff shall be treated utilizing Erosion and Sediment Controls (ESC) and Best Management Practices (BMPs) as identified in the Erosion Control Plan, SWPPP, and the recommendations of the QSD / QSP to the standards defined in the State Construction General Permit prior to discharging from the project site or to any type of private or public storm water conveyance system (natural watercourses, streets, gutters, concrete-lined v-ditches, storm drains, flow-lines, inlets, outlets, etc.). All un-treated discharges are prohibited from entering any storm water conveyance system year round.
 - Erosion and Sediment Control (ESC): All ESC measures shall be inspected, restored, repaired or modified year-round throughout the site to protect perimeters, adjacent properties, environmentally-sensitive areas and all private/public storm water conveyance systems. If any erosion or sediment controls fail during any rain event, alternate measures shall be employed at the direction of the site QSD / QSP to more adequately address the erosion or sediment problems.
 - Erosion Controls: Erosion controls shall include, but are not limited to applying and establishing: vegetative cover, wood mulch, staples or pinned blankets (straw, coconut or other), polypropylene mats or spray-on controls to all disturbed areas. Jute netting shall not be used as a stand-alone erosion control. Hydroseed with blown straw and/or a tackifier shall be utilized for all disturbed areas and fiber rolls shall be installed on slopes greater than or equal to 3:1 (at an appropriate interval).
 - Sediment Controls: Sediment controls shall include, but are not limited to: desilting basins, graded berms, fiber rolls, silt fences, check dams, drainage inlet protection, etc. Fiber rolls shall be installed at appropriate increments along the inside face of the slope. Silt fence or fiber rolls shall be installed along interior streets or inside the sidewalk, right-of-way, or back of curbs, with appropriate inlet protection measures employed.
 - Best Management Practices (BMP's): Pollution prevention measures, also known as Best Management Practices (BMP's), must be installed year-round within 14 days of any field activities. BMP handbooks can be downloaded at www.camphandbooks.com. Additional BMP measures must be installed and maintained prior to and throughout each rainy season. The developer/contractor is responsible for BMP measures throughout the duration of the project for all clearing, diking, grading, excavating and stockpiling activities, and on all exposed slopes and inactive pads throughout the entire site. If any BMP fails during any rain event, alternate measures shall be employed at the direction of the site QSD / QSP to more adequately address the erosion or sediment problems.
 - Stockpiling of BMP's: Sufficient material for BMP implementation shall be stockpiled at various locations throughout the site for immediate use prior to any forecast rain event. In emergency situations, the developer/contractor shall immediately make equipment and workers available to protect the site.
 - Perimeter Protection: Perimeter protection must be installed prior to any clearing activities. Clearing shall be limited to areas that will be immediately graded or disturbed. A combination of ESC measures shall be implemented in areas that have been cleared. All disturbed areas of an inactive site shall also be protected.
 - Construction Access Points: Construction access points shall be stabilized with rock and/or shaker plates year-round to prevent track-out. Interior access points (all proposed driveways, material storage and staging area entrances/exists, etc) shall also be protected to prevent track-out onto interior streets. Street sweeping by vacuum track shall be performed on all paved streets where tracking is observed.
 - Material Storage: Material storage and staging areas shall be established. Field tanks, portable toilets, liquids, gels, powders, landscape materials and stockpiles of soil shall be stored away from all private/public storm water conveyance systems, sidewalks, right-of-ways and flow-lines and shall have secondary containment. Inactive stockpiles of soil shall be covered at all times. Active stockpiles shall be stabilized prior to a forecast rain event.
 - Construction Waste: Construction waste and miscellaneous debris shall be placed in water-tight bins. Wire mesh receptacles shall not be allowed. Wash-out stations shall be provided for concrete, paints, stucco and other liquid waste, and shall be lined with plastic and located away from public right-of-ways, flow lines, etc. Prior to any forecast rain, bins and wash-outs shall be covered with lids or plastic tarps.
 - Slope Protection: Storm water runoff shall be directed away from slopes where feasible. If runoff can't be redirected, additional ESC measures shall be utilized to maintain the slope integrity. ESC measures are required on all exposed slopes until sufficient/permanent landscape is established.
 - Maintenance: All on-site and off-site drainage conveyance ditches, drains, gutters, check dams, silt fences and desilting basins shall be free of sediment, construction materials, waste, miscellaneous debris and deteriorated ESC measures year-round.
 - All areas undergoing grading and all other construction activities shall be watered or other dust-palliative measures used to prevent dust as conditions warrant. Water trucks shall be available at all times. The person responsible for dust control shall be available by phone 24 hours a day. Contact: Stan Ploof (925) 595-5965

RECORD DRAWING
 THESE ARE THE FINAL CONSTRUCTION PLANS FOR THE PROJECT WITH THE ADDITIONS NOTED FOR FIELD CHANGES BROUGHT TO THE ATTENTION OF THE ENGINEER BY THE DEVELOPER, CONTRACTOR, AND THE CITY INSPECTOR.

CHRISTIAN T. RAGAN
 RCE #60473

PLANS PREPARED UNDER THE DIRECTION OF:
 BY: JAMES F. TEMPLETON JR. RCE #43061

Mackay & Sumps
 ENGINEERS
 PLEASANTON, CA (925)225-0690

LATHROP GENERATIONS CENTER
 PARKING LOT
EROSION CONTROL PLAN

DEPARTMENT OF PUBLIC WORKS
 CITY OF LATHROP, CALIFORNIA

DATE: FEBRUARY 2020
 SCALE: AS NOTED
 DRAWN BY: JF
 DESIGNED BY: JF
 CHECKED BY: JFT

RECOMMENDED FOR APPROVAL BY: DATE: _____

PROJECT NO. 25227.010
 SHEET NO. CB
 SHEET 8 OF 8

NO.	DESCRIPTION	CHECKED BY	CITY APPROVAL APPROVED BY DATE