

ADDENDUM NO. 1 – September 14, 2021

**Manuel Valverde Park Shelter Improvements
CIP PK 22-08**

This addendum amends the Contract Drawings and Specifications for this project as follows:

1. Replace CONTRACTOR’S LICENSE CLASSIFICATION, page 5 in Section 100 *Instructions to Bidders* of the Contract Specifications with the following:

CONTRACTOR’S LICENSE CLASSIFICATION

In accordance with the provisions of California Public Contract Code Section 3300, the CITY OF LATHROP has determined that the Contractor must possess a valid Class “A” or Class “B” license at the time of bid submission and maintain said license throughout completion of work necessary if awarded bid. Failure to possess the specified license shall render the Bid as non-responsive and shall act as a bar to award of the Contract to any bidder not possessing said license at the time of bid submission.

2. Delete EXPERIENCE OF BIDDERS, page 5 in Section 100 *Instructions to Bidders* of the Contract Specifications.
3. See Attachment “A”, Shade Shelter General Requirements for shade shelter dimensions and column pier details.
4. Contractor shall purchase and supply both shade shelters.
5. Replace the second paragraph of 2. General Scope of Project and Work, page 1 in Section 500 *Sample Contract* of the Contract Specifications with the following:

The work to be performed under this contract includes all work contained in the Construction Documents, as detailed in Paragraph 3 below, including, but not limited to removal and disposal of two existing shade structures and concrete slabs and all existing furniture, construction of two concrete slabs, and the assembly and installation of two shade structures and tables and benches, and any tasks necessary to accomplish the aforementioned tasks.

6. Bid Deadline has been extended to **2:00 PM, September 28, 2021.**

The following Requests for Information (RFI) have been received by the City, and are followed by the City's answer (A):

R1: Is there a job walk scheduled for this project.

A1: No job walk has been scheduled for this project

When submitting the bid for the project, the Contractor must acknowledge receipt of the addendum.

Recommended by: Ken Reed 9-14-2021
Ken Reed Date
Senior Construction Manager

Approved by: Michael King 9-14-2021
Michael King Date
Public Works Director

PK 22-08 Manuel Valverde Park Shelter Improvements – ADDENDUM 1

ATTACHMENT A - Shade Shelter General Requirements

1. Shelter Column Pier Base Detail

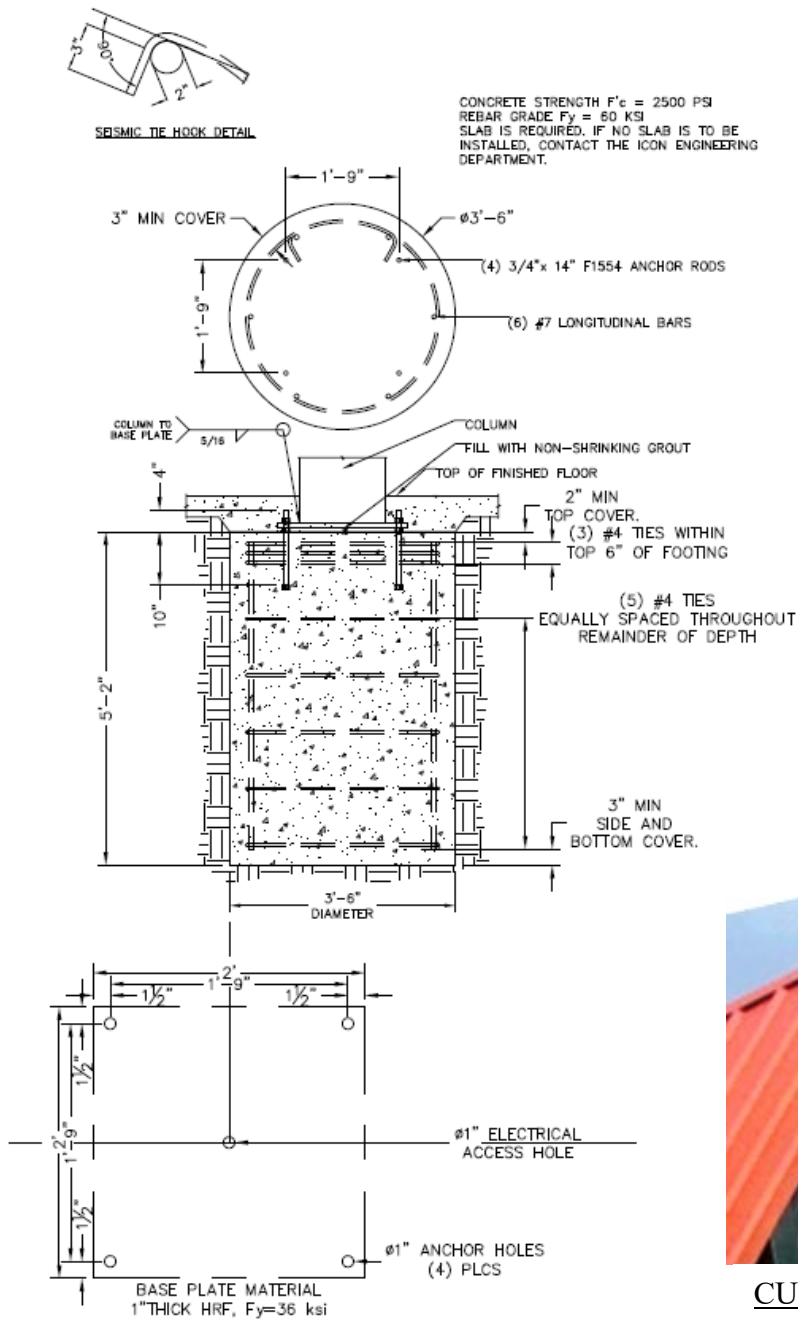

CUSTOM GABLE ORNAMENTATION

Includes:

- King Post
- Struts
- Tie Beam

2. Senior Center Shelter Layout

poligon[®]

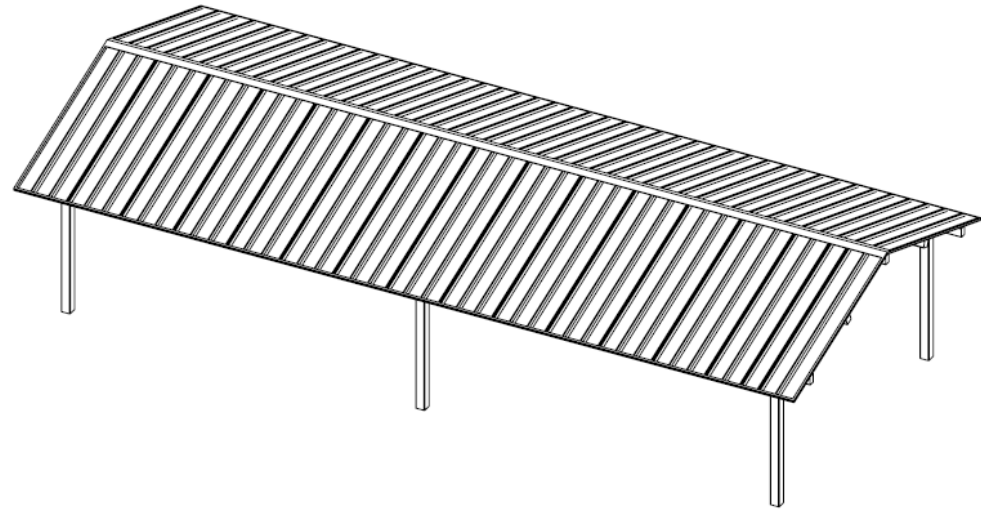

PROJECT: _____
 LOCATION: _____
 BUILDING TYPE: REK 20x44
 ROOF TYPE: MULTI-RIB

DRAWING LIST:

SHEET NUMBER	DRAWING DESCRIPTION
CS	COVER SHEET
1	ARCHITECTURAL ELEVATIONS
2	STRUCTURAL FRAMING PLAN
3	COLUMN LAYOUT

FABRICATOR APPROVALS:
 CITY OF PHOENIX, AZ APPROVED FABRICATOR #C08-2010
 CITY OF LOS ANGELES, CA APPROVED FABRICATOR #1598
 CITY OF RIVERSIDE, CA APPROVED FABRICATOR #SP08-0033
 CITY OF HOUSTON, TX APPROVED FABRICATOR #470
 CLARK COUNTY, NV APPROVED FABRICATOR #294
 STATE OF UTAH APPROVED FABRICATOR 02008-14

CERTIFICATES:
 MIAMI-DADE COUNTY CERTIFICATE OF COMPETENCY NO. 16-1025.01
 PCI (POWDER COATING INSTITUTE) 4000 CERTIFIED

MATERIALS:

DESCRIPTION	ASTM DESIGNATION
TUBE STEEL	A500 (GRADE B)
SCHEDULE PIPE	A53 (GRADE B)
RMT PIPE	A519
LIGHT GAGE COLD FORMED	A1003 (GRADE 50)
STRUCTURAL STEEL PLATE	A36
ROOF PANELS (STEEL)	A653

GENERAL NOTES:
 UNLESS NOTED OTHERWISE, THIS STRUCTURE WAS DESIGNED TO ONLY SUPPORT WHAT IS SHOWN ON THESE DRAWINGS. POLIGON MUST BE CONTACTED IF ANYTHING ELSE IS TO BE ATTACHED TO THIS STRUCTURE (WALLS, COLUMN WRAPS, RAILINGS, ETC.) SO THE DESIGN OF THIS STRUCTURE CAN BE REVIEWED AND POSSIBLY REVISED.

UNLESS NOTED OTHERWISE, THIS STRUCTURE WAS DESIGNED ASSUMING A 20' SEPARATION BETWEEN ANY ADJACENT STRUCTURE WITH AN EAVE HEIGHT EQUAL TO OR GREATER THAN THE EAVE HEIGHT OF THIS STRUCTURE. IF THAT SEPARATION DOES NOT EXIST POLIGON MUST BE CONTACTED SO THE DESIGN OF THIS STRUCTURE CAN BE REVIEWED AND POSSIBLY REVISED.

STRUCTURAL STEEL SHALL BE DETAILED, FABRICATED, AND ERECTED IN ACCORDANCE WITH THE LATEST EDITION OF THE AMERICAN INSTITUTE OF STEEL CONSTRUCTION (AISC) SPECIFICATION MANUAL.

ALL WELDING IS PERFORMED BY AMERICAN WELDING SOCIETY CERTIFIED WELDERS AND CONFORMS TO THE LATEST EDITION OF AWS D1.1 OR D1.3 AS REQUIRED.

PARTS SHOWN MAY BE UPGRADED DUE TO STANDARDIZED FABRICATION. REFER TO THE SHIPPING BILL OF MATERIALS FOR POSSIBLE SUBSTITUTIONS.

FOR PROPER FIELD INSTALLATION OF THE BUILDING IT IS RECOMMENDED THAT THE PRIMARY FRAME INSTALLER AND THE ROOF INSTALLER HAVE A MINIMUM FIVE (5) YEARS DOCUMENTED EXPERIENCE INSTALLING THIS TYPE OF PRODUCT.

FOR PROPER FIELD INSTALLATION OF THE BUILDING IT IS RECOMMENDED THAT ELECTRIC WIRING, IF REQUIRED, BE RUN THROUGH THE STRUCTURAL MEMBERS BEFORE THE BUILDING IS ERECTED.

STOP!!
NOT FOR CONSTRUCTION
 USE FOR PRELIMINARY
 PLANNING AND ESTIMATING
 ONLY

DRAWING: COVER SHEET		REV LEVEL: A	SHEET
SCALE: 1:64	www.poligon.com (616)399-1963		CS
 by PORTERCORP			
<small> COPYRIGHT 2014 PATENTED OR PATENTS PENDING PORTERCORP 4240 N. 126th AVE HOLLAND, MI 48048 </small>			

BASEPLATE NOTES:

1. POLIGON ENGINEERING WILL DETERMINE REQUIRED BASEPLATE DESIGN AFTER ENGINEERING PACKAGE IS ORDERED.
2. CUSTOMER MAY SUGGEST PREFERRED BASEPLATE DESIGN.

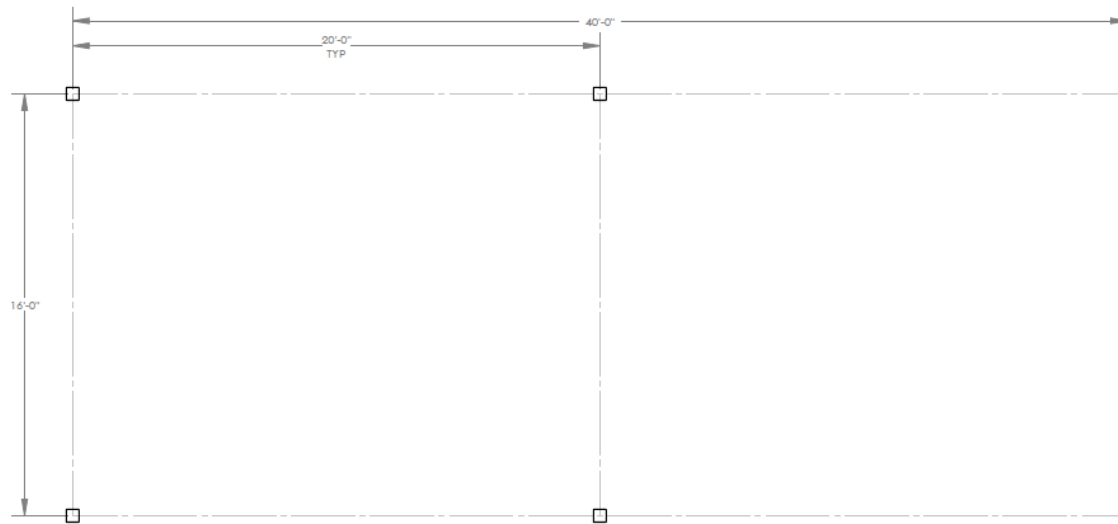

STOP!!
NOT FOR CONSTRUCTION

USE FOR PRELIMINARY
PLANNING AND ESTIMATING
ONLY

DRAWING: COLUMN LAYOUT	
SCALE: 1:48	REV LEVEL: A
poligon [®] <small>COPYRIGHT 2016 PATENTS OR PATENTS PENDING PORTERCORP 4240 N. 158th AVE HOLLAND, MI 48424</small>	(616)399-1963 www.poligon.com by PORTERCORP
	SHEET 3

3. Community Center Shelter Layout

poligon®

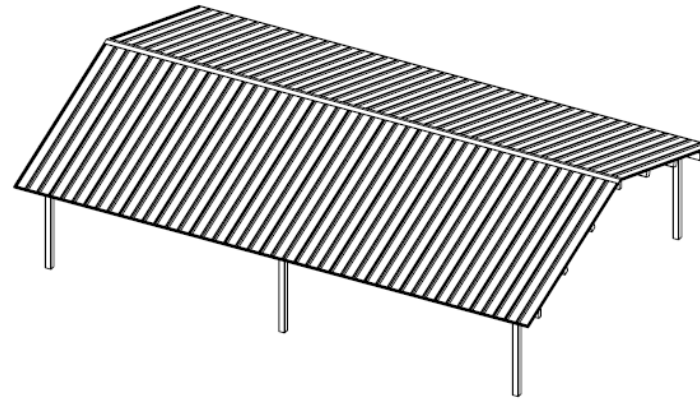

PROJECT: _____
 LOCATION: _____
 BUILDING TYPE: REK 30x44
 ROOF TYPE: MULTI-RIB

DRAWING LIST:

SHEET NUMBER	DRAWING DESCRIPTION
CS	COVER SHEET
1	ARCHITECTURAL ELEVATIONS
2	STRUCTURAL FRAMING PLAN
3	COLUMN LAYOUT

FABRICATOR APPROVALS:
 CITY OF PHOENIX, AZ APPROVED FABRICATOR #C08-2010
 CITY OF LOS ANGELES, CA APPROVED FABRICATOR #1598
 CITY OF RIVERSIDE, CA APPROVED FABRICATOR #SP06-0033
 CITY OF HOUSTON, TX APPROVED FABRICATOR #470
 CLARK COUNTY, NV APPROVED FABRICATOR #264
 STATE OF UTAH APPROVED FABRICATOR 02008-14

CERTIFICATES:
 MIAMI-DADE COUNTY CERTIFICATE OF COMPETENCY NO. 16-1025.01
 PCI (POWDER COATING INSTITUTE) 4000 CERTIFIED

MATERIALS:

DESCRIPTION	ASTM DESIGNATION
TUBE STEEL	A500 (GRADE B)
SCHEDULE PIPE	A53 (GRADE B)
RMT PIPE	A519
LIGHT GAGE COLD FORMED STRUCTURAL STEEL PLATE	A1003 (GRADE 50)
ROOF PANELS (STEEL)	A36 A853

GENERAL NOTES:
 UNLESS NOTED OTHERWISE, THIS STRUCTURE WAS DESIGNED TO ONLY SUPPORT WHAT IS SHOWN ON THESE DRAWINGS. POLIGON MUST BE CONTACTED IF ANYTHING ELSE IS TO BE ATTACHED TO THIS STRUCTURE (WALLS, COLUMN WRAPS, RAILINGS, ETC.) SO THE DESIGN OF THIS STRUCTURE CAN BE REVIEWED AND POSSIBLY REVISED.

UNLESS NOTED OTHERWISE, THIS STRUCTURE WAS DESIGNED ASSUMING A 20' SEPARATION BETWEEN ANY ADJACENT STRUCTURE WITH AN EAVE HEIGHT EQUAL TO OR GREATER THAN THE EAVE HEIGHT OF THIS STRUCTURE. IF THAT SEPARATION DOES NOT EXIST, POLIGON MUST BE CONTACTED SO THE DESIGN OF THIS STRUCTURE CAN BE REVIEWED AND POSSIBLY REVISED.

STRUCTURAL STEEL SHALL BE DETAILED, FABRICATED, AND ERECTED IN ACCORDANCE WITH THE LATEST EDITION OF THE AMERICAN INSTITUTE OF STEEL CONSTRUCTION (AISC) SPECIFICATION MANUAL.

ALL WELDING IS PERFORMED BY AMERICAN WELDING SOCIETY CERTIFIED WELDERS AND CONFORMS TO THE LATEST EDITION OF AWS D1.1 OR D1.3 AS REQUIRED.

PARTS SHOWN MAY BE UPGRADED DUE TO STANDARDIZED FABRICATION. REFER TO THE SHIPPING BILL OF MATERIALS FOR POSSIBLE SUBSTITUTIONS.

FOR PROPER FIELD INSTALLATION OF THE BUILDING IT IS RECOMMENDED THAT THE PRIMARY FRAME INSTALLER AND THE ROOF INSTALLER HAVE A MINIMUM FIVE (5) YEARS DOCUMENTED EXPERIENCE INSTALLING THIS TYPE OF PRODUCT.

FOR PROPER FIELD INSTALLATION OF THE BUILDING IT IS RECOMMENDED THAT ELECTRIC WIRING, IF REQUIRED, BE RUN THROUGH THE STRUCTURAL MEMBERS BEFORE THE BUILDING IS ERECTED.

STOP!!
 NOT FOR CONSTRUCTION
 USE FOR PRELIMINARY
 PLANNING AND ESTIMATING
 ONLY

DRAWING: COVER SHEET		REV LEVEL: A
SCALE: 1:96	(616)399-1963	
 www.poligon.com by PORTERCORP		SHEET CS
<small>COPYRIGHT 2014 PORTERCORP 4082 N. 138th AVE. HOLLAND, MI 48034</small>		

BASEPLATE NOTES:

1. POLIGON ENGINEERING WILL DETERMINE REQUIRED BASEPLATE DESIGN AFTER ENGINEERING PACKAGE IS ORDERED.
2. CUSTOMER MAY SUGGEST PREFERRED BASEPLATE DESIGN.

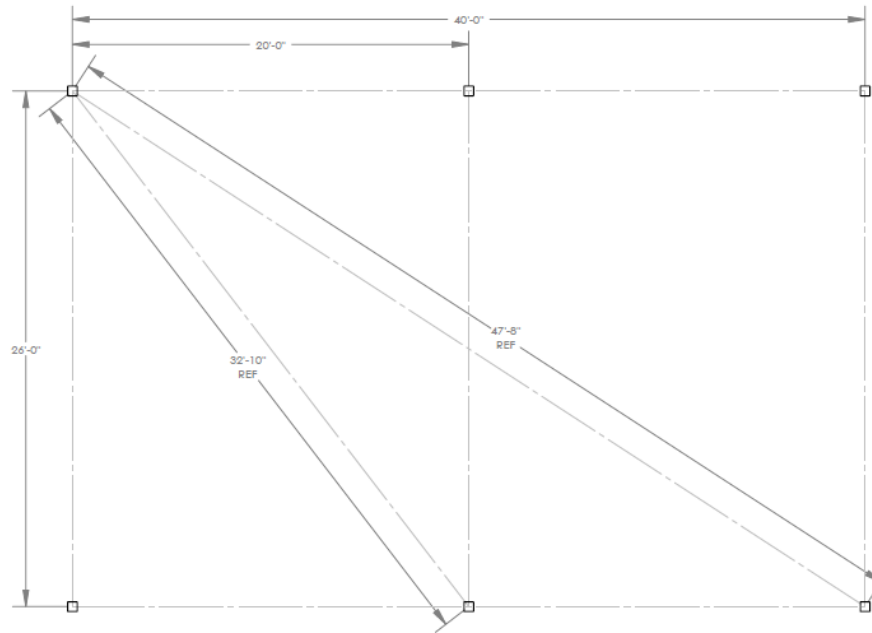

STOP!!
NOT FOR CONSTRUCTION
USE FOR PRELIMINARY
PLANNING AND ESTIMATING
ONLY

DRAWING: COLUMN LAYOUT	
SCALE: 1:64	REV LEVEL: A
poligon [®] <small>COPYRIGHT 2016. PATENTED OR PATENTS PENDING PORTERCORP 4240 N. 134th AVE HOLLAND, MI 48034</small>	(616)399-1963 www.poligon.com by PORTERCORP
	SHEET 3